

1 Your mobile

Keys in idle mode

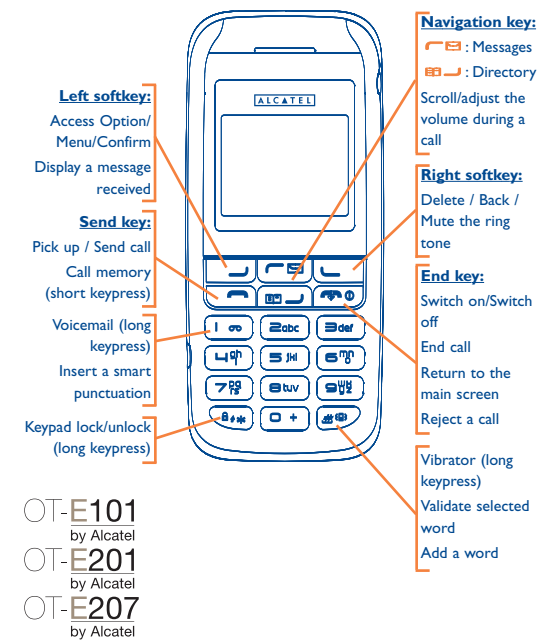

1

2 Getting started

2.1 Remove the back cover

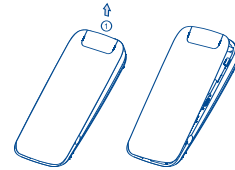

2.2 Insert the SIM Card

Inserting the SIM card in order to use your phone. To insert your SIM card, turn off your phone by holding down the **End key**.

Fit the SIM card with the chip (indicated by the gold connectors) facing downwards. Slide the SIM card into its compartment taking care of the correct orientation with the angled corner. Push the SIM card with your finger to release it.

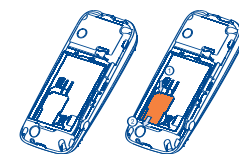

2.3 Insert and remove the battery

To remove the battery, make the same thing in the other direction.

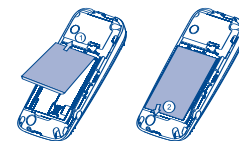

2

3 Menu

Select the item you require using the navigation keys (**Left softkey**, **Right softkey**), then press again the left softkey to confirm.

- Tools:**
Access the Alarm and Calculator functions.
- Call services:**
Access functions such as: voicemail number, call memory, call settings, network, forward and call barring.
- Messages:**
Read, write and send your SMS. View your messages in your inbox, outbox. Adjust the settings and activate/deactivate SMS CB ⁽¹⁾ message reception.
- Directory:**
Access/create directory files and make calls from your directory.
- Sounds:**
Change the mode, volume, ringtones, alerts, power on/off sounds, key beep.
- Display:**
Change the main screen wallpaper, colours/contrast, power on/off display, screensaver and contrast.
- Settings:**
Set the time, date, language, security mode, answer mode, etc
- Games:**
Play the 2 games embedded in your telephone.
- Services ⁽²⁾:**
Access the Operator services.

⁽¹⁾ Contact your network operator to check service availability.
⁽²⁾ Depending on your operator's network.

3

4 Main screen icons

- Battery charge level.**
- Vibrate mode ⁽¹⁾**
- Silence mode ⁽²⁾**
- Unread message.**
- Message list is full**
- Unanswered call**
- Call forwarding activated:** your calls are forwarded
- Alarm programmed**
- Signal strength indicator.**
- Keypad lock.**
- Roaming.**

⁽¹⁾ For E201/E207 only
⁽²⁾ For E101 also means vibrate mode

5 Tools

5.1 Alarm

+ **Left softkey** = "snooze": The alarm will ring again after 5 minutes.
+ **Right softkey** = "cancel"

When the phone is switched off, the alarm will ring.

5.2 Calculator

Left softkey + **Right softkey** = 2
select type of operation

6 Calls

6.1 Making a call

Dial number then press **Send key**.

To hang up, press **End key**.

If you make a mistake, press **Left softkey**. Press and hold the key to delete all the digits.

Making an emergency call

Dial 112 or any other number and press **Send key**. Emergency calls can be performed at any time without your SIM card or PIN code. Once the call has been made, the screen will display: "SOS".

Making an international call

Hold down **Left softkey** when "+" is displayed, enter the country and area codes, then complete the number and send the call.

Calling a number from the directory

Press the **Left softkey** key to access the directory. Select the desired phone number and press **Send key**.

6.2 Calling your voicemail ⁽¹⁾

Make a long keypress on the **Send key**.

6.3 Available functions during the call

Access the available options during a call by pressing **Left softkey**.

⁽¹⁾ Contact your network operator for more information.

7 Messages

Press **Left softkey** or press **Left softkey** and select **Messages**.

7.1 Create an SMS

Left softkey → "create" → **Left softkey** → **Left softkey**

and choose your action:

Send: send the message to a recipient.

Send to many: send the message to a group of people you have defined

Send to email: send a message to an email address ⁽¹⁾.

Save: save the message in the unsent box and send it later.

Templates: use or modify an existing message.

Discard: discard the message.

Predictive (T9): select this mode to enter the words more quickly.

T9 help: help menu for the predictive mode

7.2 Read an SMS

In the inbox, read and unread messages are shown with different icon.

The outbox included sent and unsent messages.

7.3 Inbox/Outbox

Select the message and press and choose your option: Reply/Delete/Forward message/Archives/Modify/Extract number/Call number.

⁽¹⁾ Contact your network operator for service availability.

6

8 Directory

You may store up to 250 entries in the phone memory.

8.1 Directory menu

View: access the list contacts (alphabetic order).

Create: enter number and name of a new contact.

Delete: delete the selected contact.

Copy: copy the selected contact from the SIM memory to the phone memory and vice versa.

Caller group: group together names by category.

Select Dir.: select the SIM directory, Phone directory or both at the same time.

Memory status: check the numbers of contacts and the memory space left.

My number: enter your own phone numbers for future reference.

Speed Dial: set up speed dial for each key from **2abc** to **9###**.

8.2 Creating a contact

Left softkey select "create" and enter number and name of a new contact.

8.3 Consulting your directory ("View")

Select "Dir." then "View" to access the list of your contacts

Available options in the contact list

Once you have selected a name, press to access the following options:

Call number/Send message/Details/Modify/Delete/Copy/Caller group/Search number.

Caller group

You can group together names by category and select a special ringtone. For each group, you can select the following options:

Modify/Ringtone/SMS alert/Members/Add member/Delete all.

⁽¹⁾ OT-E201, OT-E207

⁽²⁾ OT-E101

7

9 Sounds

From the main screen **Left softkey** → **Left softkey** and select one of the following options in order to customise your telephone.

9.1 Mode

Ringtone: only the tone is played.

Vibrate: only vibrator is set (but the alarms and low battery sound will be played anyway).

Vibrate & ring: vibrator and tone at the same time.

Vibrate then ring: vibrator then tone.

Vibrate.Beep.Ring: vibrator then warning beep, then tone.

Silence: no sound no beep (but the alarms and low battery sound will be played anyway).

9.2 Volume

The volume can be adjusted to one of the set levels.

10 Display

10.1 Wall paper ⁽¹⁾

Select the image you wish to be displayed as the idle screen.

10.2 Colours ⁽¹⁾/Reverse ⁽²⁾

Choose different colors for the presentation of the screen.

10.3 Contrast

Set the contrast of your phone by choosing one of the 5 levels proposed.

10.4 Backlight

Select the display backlight duration : 7s, 15s, 20s, 30s.

11 Settings

11.1 Clock

Set time and date, time format, display (show or hide the clock).

11.2 Languages

To choose the language in which the messages will be displayed.

11.3 Dictionary

Create, modify or delete a word in your personal dictionary. When creating a SMS, the word of this dictionary are automatically called if you choose the Predictive Mode (T9).

11.4 Auto keypad lock

To select the timing for the automatic locking of the keypad when the handset is not in use. From this function you may select a timing of 5 to 40 seconds, or to set it "off" if you prefer to lock it manually.

11.5 Auto power

11.6 Answer mode

11.7 Factory reset

⁽¹⁾ Contact your network operator for more information.

9

12 Call services

12.1 Call memory

From the main screen, press **Left softkey** and your phone display a call list. Each call is displayed with an icon indicating the type of the call.

Select a telephone number in the list and press **Left softkey** to redial it or press **Right softkey** to access the following options :

Details: display the information of the call selected.

Save number: store the number in your directory.

Send message: create an SMS.

Call number: call the selected number.

Modify: modify the number, then call it or save it.

Delete: delete the number selected.

Delete all: delete the entire list.

12.2 Call settings ⁽¹⁾

Minute alert/Call waiting/Auto redial/Billing/Duration/Amount/Hide my ID.

12.3 Call services ⁽¹⁾

Network/Call forwarding/Call barring.

13 Games

13.1 Russia

The aim of this game is to make as many complete lines of bricks as possible.

Key functions:

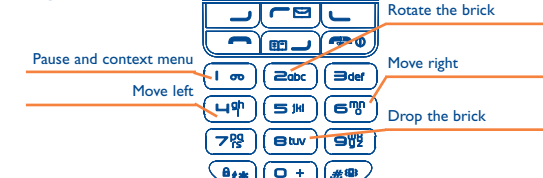

Toggle the upgrade level flag: if the flag is on, the game level will move up when your score increase 300. The level impacts the speed of the bricks : the higher the level, the higher the speed.

13.2 Bricks

The aim is to break as many bricks as possible with a bat and ball.

3 lives per game.

Miss a ball = lose a life

Bonus depending on the position in which the ball hits the bricks.

Key functions:



Alcatel logo and Alcatel name are Trademark of Alcatel-Lucent used under license by T&A Mobile Phones Limited.

All rights reserved © Copyright 2007
T&A Mobile Phones Limited.

T&A Mobile Phones Limited reserves the right to alter material or technical specification without prior notice.

4

10

11

12

Safety and use

We recommend that you read this chapter carefully before using your phone. The manufacturer disclaims any liability for damage, which may result as a consequence of improper use or use contrary to the instructions contained herein.

***TRAFFIC SAFETY:**
Given studies, which show that using a mobile phone while driving a vehicle constitutes a real risk, even when the hands-free kit is used (car kit, headset...), drivers are requested to refrain from using their mobile when the vehicle is not parked.

When switched on, your phone emits electromagnetic waves that can interfere with the vehicle's electronic systems such as ABS anti-lock brakes or airbags. To ensure that there is no problem:

- do not place your phone on top of the dashboard or within an airbag deployment area,
- check with your car dealer or the car manufacturer to make sure that the dashboard is adequately shielded from mobile phone RF energy.

*** CONDITIONS OF USE:**
Switch the phone off before boarding an aircraft.

Switch the phone off when you are in health care facilities, except in designated areas. As with many other types of equipment now in regular use, mobile telephones can interfere with other electrical or electronic devices, or equipment using radio frequency.

Switch the phone off when you are near gas or flammable liquids. Strictly obey all signs and instructions posted in a fuel depot, petrol station, or chemical plant, or in any potentially explosive atmosphere.

When the phone is switched on, it should be kept at least 15 cm from any medical devices such as a pacemaker, a hearing aid or insulin pump, etc. In particular when using the phone, you should hold it against the ear on the opposite side to the device, if any.

To avoid hearing impairment, pick up the call before holding your phone to your ear. Also move the handset away from your ear while using the "hands-free" mode because the amplified volume might cause hearing damage.

Do not let small children use the phone without supervision.

When replacing the cover please note that your phone may contain substances that could create an allergic reaction.

Always handle your phone with care and keep it in a clean and dust-free place. You are advised to switch off the telephone from time to time to optimise its performance.

Do not allow your phone to be exposed to adverse weather or environmental conditions (moisture, humidity, rain, infiltration of liquids, dust, sea air, etc.). The manufacturer's recommended operating temperature range is -20°C to +55°C. Over 55°C the legibility of the phone's display may be impaired, though this is temporary and not serious.

Emergency call numbers may not be reachable on all cellular networks. You should never rely only on your phone for emergency calls.

Do not open, dismantle or attempt to repair your mobile phone yourself.

Do not drop, throw or bend your mobile phone.

Do not paint it.

Use only Alcatel batteries, battery chargers, and accessories that are compatible with your phone model. T&A Mobile Phones Limited and its affiliates disclaim any liability for damage caused by the use of other chargers or batteries.

Your phone should not be disposed of in a municipal waste. Please check local regulations for disposal of electronic products.

Remember to make back-up copies or keep a written record of all important information stored in your phone.

Some people may suffer epileptic seizures or blackouts when exposed to flashing lights, or when playing video games. These seizures or blackouts may occur even if a person never had a previous seizure or blackout. If you have experienced seizures or blackouts, or if you have a family history of such occurrences, please consult your doctor before playing video games on your phone or enabling a flashing-lights feature on your phone. Parents should monitor their children's use of video games or other features that incorporate flashing lights on the phones. All persons should discontinue use and consult a doctor if any of the following symptoms occur: convulsion, eye or muscle twitching, loss of awareness, involuntary movements, or disorientation. To limit the likelihood of such symptoms, please take the following safety precautions:

- Do not play or use a flashing-lights feature if you are tired or need sleep.
- Take a minimum of a 15-minute break hourly.
- Play in a room in which all lights are on.
- Play at the farthest distance possible from the screen.
- If your hands, wrists, or arms become tired or sore while playing, stop and rest for several hours before playing again.
- If you continue to have sore hands, wrists, or arms during or after playing, stop the game and see a doctor.

When you play games on your phone, you may experience occasional discomfort in your hands, arms, shoulders, neck, or other parts of your body. Follow the instructions to avoid problems such as tendinitis, carpal tunnel syndrome, or other musculoskeletal disorders.

This symbol on your telephone, the battery and the accessories means that these products must be taken to collection points at the end of their life:

- Municipal waste disposal centres with specific bins for these items of equipment
- Collection bins at points of sale.

They will then be recycled, preventing substances being disposed of in the environment, so that their components can be reused.

In European Union countries:

These collection points are accessible free of charge. All products with this sign must be brought to these collection points.

In non European Union countries:

Items of equipment with this symbol are not to be thrown into ordinary bins if your country or your region has suitable recycling and collection facilities; instead they are to be taken to collection points for them to be recycled.

*** PRIVACY:**

Please note that you must respect the laws and regulations in force in your country regarding taking photographs and recording sounds with your mobile telephone. Pursuant to such laws and regulations, it may be strictly forbidden to take photographs and/or to record the voices of other people or any of their personal attributes, and duplicate or distribute them, as this may be considered to be an invasion of privacy. It is the user's sole responsibility to ensure that prior authorization be obtained, if necessary, in order to record private or confidential conversations or take a photograph of another person; the manufacturer, the seller or vendor of your mobile phone (including the operator) disclaim any liability which may result from the improper use of the mobile phone.

*** BATTERY:**

Before removing the battery from your phone, please make sure that the phone is switched off. Observe the following precautions for battery use:

- Do not attempt to open the battery (due to the risk of toxic fumes and burns).
- Do not puncture, disassemble or cause a short-circuit in a battery,
- Do not burn or dispose of a used battery in household rubbish or store it at temperatures above 60 °C.

Batteries must be disposed of in accordance with locally applicable environmental regulations. Only use the battery for the purpose for which it was designed. Never use damaged batteries or those not recommended by T&A Mobile Phones Limited and/or its affiliates.

*** CHARGERS:**

Mains powered chargers will operate within the temperature range of 0 °C to 40 °C. The chargers designed for your mobile phone meet with the standard for safety of information technology equipment and office equipment use. They should be used for this purpose only.

*** RADIO WAVES:**

Proof of compliance with international standards (ICNIRP) or with European Directive 1999/5/EC (R&TTE) is required of all mobile phone models before they can be put on the market. The protection of the health and safety for the user and any other person is an essential requirement of these standards or this directive. THIS MOBILE PHONE COMPLIES WITH INTERNATIONAL AND EUROPEAN REQUIREMENTS REGARDING EXPOSURE TO RADIO WAVES.

Your mobile phone is a radio transmitter/receiver. It was designed and manufactured to comply with the radiofrequency (RF) exposure thresholds recommended by international requirements (ICNIRP) ⁽¹⁾ and by the Council of the European Union (Recommendation 1999/519/EC) ⁽²⁾.

These limits are part of a set of requirements and establish authorised radiofrequency levels for the public. These limits were established by independent groups of experts on the basis of regular and detailed scientific assessments. They include a significant safety margin intended to ensure the safety of all, regardless of age or state of health.

The exposure standard for mobile phones is determined by a measurement unit known as the Specific Absorption Rate or "SAR". The SAR limit is set by international requirements or by the Council of the European Union at 2 watts/kilogram (W/kg) averaged over 10 grams of body tissue. The tests used to determine SAR levels were carried out on the basis of standard usage modes with the phones transmitting at their maximum power level over the entire range of frequency bands.

⁽¹⁾ The ICNIRP requirements are applicable in the following regions: Central America (except Mexico), South America, North and South Africa, Pacific Asia (except Taiwan and Korea), Australia.

⁽²⁾ The European recommendation (1999/519/EC) is applicable in the following regions: Europe, Israel.

Troubleshooting

Before contacting the aftersales department, you are advised to follow the instructions below:

- You are advised to switch off the telephone from time to time to optimise its performance.
- You are advised to fully charge the battery () for optimal operation.
- Avoid storing large amounts of data in your telephone as this may affect the performance of your telephone.

and carry out the following checks:

My mobile phone does not switch on

- Press  until the screen comes on
- Check the battery charge level
- Check the battery contacts, remove and reinstall your battery, then turn your telephone back on

My phone does not respond since several minutes

- Press the  key
- Remove the battery and re-insert it, then switch the phone back on

My screen is difficult to read

- Clean your screen
- Use your mobile phone in accordance with the recommended conditions of use

My mobile phone turns off by itself

- Check that your keypad is locked when you are not using your mobile phone
- Check the battery charge level
- Check that the function "Auto OFF" is not activated.

Although the SAR was established at the highest certified level, the actual SAR level for the mobile phone during use is generally much lower than the maximum values. In fact, since mobile phones are designed to operate at many different power levels, they only use the minimum level of power required to provide a connection to the network. In theory, the closer you are to a base station antenna, the lower the power level required by the mobile phone.

The highest tested SAR value for this mobile phone for use at the ear and compliance against the standard is 1.1 W/kg. While there may be differences between the SAR levels on various phones and at various positions, they all meet the relevant International guidelines and EU requirements for RF (radio-waves) exposure.

The World Health Organisation (WHO) considers that present scientific information does not indicate the need for any special precautions for use of mobile phones. If individuals are concerned, they might choose to limit their own or their children's RF exposure by limiting the length of calls, or using "hands-free" devices to keep mobile phones away from the head and body (fact sheet n° 193). Additional information about electromagnetic fields and public health are available on the following site: <http://www.who.int/peh-emf>.

Your telephone is equipped with a built-in antenna. For optimal operation, you should avoid touching it or damaging it.

General information

• **Website:** www.tctmobile.com

• **Hot Line Number:** see the "TCL & Alcatel Mobile Phones Services" leaflet or go to our Internet site.

On our Internet site, you will find our FAQ (Frequently Asked Questions) section. You can also contact us by e-mail to ask any questions you may have.

Your telephone is a transceiver that operates on GSM networks with 900 and 1800 MHz bands.

The  marking indicates that your telephone complies with "1999/5/EC (R&TTE)" directive and that the accessories concerned comply with current EC directives. The entire copy of the Declaration of Conformity for your telephone can be obtained through our website: www.tctmobile.com.

Protection against theft ⁽¹⁾

Your telephone is identified by an IMEI (phone serial number) shown on the packaging label and in the product's memory. We recommend that you note the number the first time you use your telephone by entering *#06# and keep it in a safe place. It may be requested by the police or your operator if your telephone is stolen. This number allows your mobile telephone to be blocked preventing a third person from using it, even with a different SIM card.

Disclaimer

There may be certain differences between the user manual description and the phone's operation, depending on the software release of your telephone or specific operator services.



T9 Text Input is licensed under one or more of the following: U.S. Pat. Nos. 5,187,480, 5,818,437, 5,945,928, 5,953,541, 6,011,554, 6,286,064, 6,307,548, 6,307,549, and 6,636,162, 6,646,573; European Pat. Nos. 0 842 463 (96927260.8), 1 010 057 (98903671.0), 1 018 069 (98950708.2); and additional patents are pending worldwide

⁽¹⁾ Contact your network operator for service availability.

Telephone warranty

Congratulations on choosing this mobile phone - we hope that you will be completely satisfied with it.

Your phone is guaranteed against any deviation from technical specifications for a period of twelve (12) months from the date specified on your original invoice ⁽¹⁾. The warranty terms defined in the manual also apply to the battery and accessories sold with the phone but for a period of six (6) months ⁽²⁾ from the date of purchase shown on your original invoice.

Under the terms of this warranty, you must immediately inform your vendor (or any repair centre approved by T&A Mobile Phones Limited or its affiliates, which are listed on our website <http://www.tctmobile.com>) in case of a conformity defect on your phone, and present the invoice given to you at the time of purchase. The vendor or maintenance centre will decide whether to replace or repair, as appropriate, all or any part of the telephone or accessory found to be defective; this warranty covers the cost of parts and labour but excludes any other costs. Repair or replacement may be carried out using reconditioned components offering equivalent functionality.

Servicing under the terms of this warranty, especially repair, modification or replacement of products, shall entitle to a ONE (1) month ⁽³⁾ warranty unless there are statutory provisions to the contrary.

This warranty shall not apply to damage or defects to your telephone and/or accessory caused by:

- 1) failure to follow the instructions for use or installation,
- 2) failure to comply with technical and safety standards applicable in the geographical area where the equipment is used.

⁽¹⁾ The mandatory period may vary if overriding statutory provisions are applicable in your country.

⁽²⁾ The life of a rechargeable Alcatel telephone battery in terms of conversation time, standby time, and total service life, will depend on the conditions of use and network configuration. Batteries being considered expendable supplies, the specifications state that you should obtain optimal performance for your Alcatel phone during the first six months after purchase and for approximately 200 more recharges.

- 3) improper maintenance of batteries and other sources of energy, and of the overall electric installation,
- 4) accidents or consequences of theft of the vehicle in which the telephone is transported, acts of vandalism, lightning, fire, humidity, infiltration of liquids, inclement weather,
- 5) connecting or integrating the phone into equipment not supplied or not recommended by T&A Mobile Phones Limited or its affiliates, without their express written consent for such,
- 6) any servicing, modification or repair performed by individuals not authorised by T&A Mobile Phones Limited or its affiliates, the vendor or the approved maintenance centre,
- 7) use of the equipment for a purpose other than that for which it was designed,
- 8) normal wear,
- 9) malfunctions caused by external causes (e.g., radio interference from other equipment, power or telephone line voltage fluctuations),
- 10) modifications made to the equipment even if required by changes in regulations and/or modification of network parameters,
- 11) faulty connections resulting from unsatisfactory radio transmission or caused by the absence of radio relay coverage.
- 12) equipment on which markings or serial numbers have been removed or altered, and handsets on which labels have been removed or deteriorated shall be excluded from the warranty.

In accordance with the applicable law, your product is warranted against hidden defects (defects inherent in the design, manufacture, etc.). There are no express warranties, whether written or oral, other than this printed limited warranty, express or implied, of any nature whatsoever.

In no event shall T&A Mobile Phones Limited or its affiliates be liable for incidental or consequential damages of any nature whatsoever, including but not limited to trading loss, commercial loss, to the full extent those damages can be disclaimed by law. Some countries/states do not allow the exclusion or limitation of incidental or consequential damages, or limitation of the duration of implied warranties, so the preceding limitations or exclusions may not apply to you.