

Nokia Bluetooth Headset BH-904 User Guide

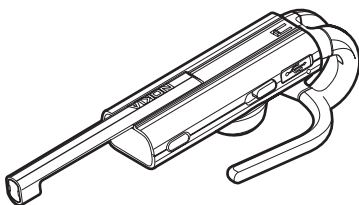

DECLARATION OF CONFORMITY

Hereby, NOKIA CORPORATION declares that this HS-101W product is in compliance with the essential requirements and other relevant provisions of Directive 1999/5/EC. A copy of the Declaration of Conformity can be found at http://www.nokia.com/phones/declaration_of_conformity/.

CE 0984

© 2008 Nokia. All rights reserved.

Nokia, Nokia Connecting People and the Nokia Original Accessories logo are trademarks or registered trademarks of Nokia Corporation. Other product and company names mentioned herein may be trademarks or tradenames of their respective owners.

Reproduction, transfer, distribution, or storage of part or all of the contents in this document in any form without the prior written permission of Nokia is prohibited.

Bluetooth is a registered trademark of Bluetooth SIG, Inc.

Nokia operates a policy of ongoing development. Nokia reserves the right to make changes and improvements to any of the products described in this document without prior notice.

To the maximum extent permitted by applicable law, under no circumstances shall Nokia or any of its licensors be responsible for any loss of data or income or any special, incidental, consequential or indirect damages howsoever caused.

The contents of this document are provided "as is". Except as required by applicable law, no warranties of any kind, either express or implied, including, but not limited to, the implied warranties of merchantability and fitness for a particular purpose, are made in relation to the accuracy, reliability or contents of this document. Nokia reserves the right to revise this document or withdraw it at any time without prior notice.

The availability of particular products may vary by region. Please check with your Nokia dealer for details.

Export controls

This device may contain commodities, technology or software subject to export laws and regulations from the US and other countries. Diversion contrary to law is prohibited.

9209964 / Issue 1 EN

Contents

1. Introduction	4	Sliding boom	10
Bluetooth wireless technology.....	4	Calls	11
2. Get started	6	Adjust the headset volume	11
Keys and parts.....	6	Mute or unmute the microphone... ..	12
Charge the battery.....	6	Switch a call between headset	
Switch the headset on or off.....	7	and mobile device.....	12
Pair and connect the headset.....	8	Connect the headset	
Disconnect the headset	8	to two devices.....	12
Reconnect the headset	9	Clear settings or reset	12
Troubleshooting.....	9	4. Battery and charger	
3. Basic use	10	information	14
Change the earplug.....	10	Care and maintenance.....	15
Place the headset on the ear.....	10		

1. Introduction

With the Nokia Bluetooth Headset BH-904, you can make and answer calls while on the move or in the office. The headset has a sliding boom that allows you to answer and end calls and to talk at a lower volume or in a noisy environment. The headset is provided with noise cancellation that helps you to handle calls in noisy environments.

You can use the headset with compatible devices that support Bluetooth wireless technology. The headset can be connected to two devices at the same time.

Read this user guide carefully before using the headset. Also, read the user guide for your mobile device that you connect to the headset. For more information, see www.nokia.com/support or your local Nokia website.

This product may contain small parts. Keep them out of the reach of small children. The surface of this device does not contain nickel in the platings. The surface of this device contains stainless steel.

■ Bluetooth wireless technology

Bluetooth wireless technology allows you to connect compatible devices without cables. The headset and the other device do not need to be in line of sight, but they should be within 10 metres (33 feet) of each other. The closer the headset and the other device are to each other, the better is the performance. The optimal operating range is shown in dark grey in the picture. The connection is subject to interference from distance and obstructions (shown in light grey) or other electronic devices.

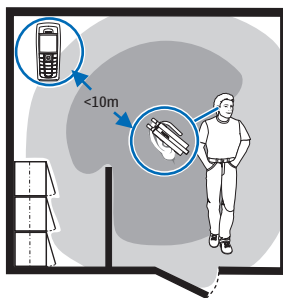

The headset is compliant with the Bluetooth Specification 2.1 + EDR supporting the Headset Profile 1.1 and Hands-Free Profile 1.5. Check with the manufacturers of other devices to determine their compatibility with this device.

2. Get started

■ Keys and parts

The headset contains the following parts:

1. Volume key
2. Sliding boom
3. Earpiece
4. Indicator light
5. Power key
6. Charger connector
7. Mute/unmute key
8. Answer/end key
9. Microphones

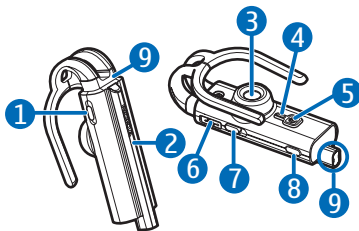

Before using the headset, you must charge the battery and pair the headset with a compatible device.

Parts of the device are magnetic. Metallic materials may be attracted to the device. Do not place credit cards or other magnetic storage media near the device, because information stored on them may be erased.

■ Charge the battery

Before charging the battery, carefully read "Battery and charger information", p. 14.



Warning: Use only chargers approved by Nokia for use with this particular model. The use of any other types may invalidate any approval or warranty, and may be dangerous.

When you disconnect the power cord of any accessory, grasp and pull the plug, not the cord.

1. Connect the charger to a wall outlet.
2. Lift the cover of the charger connector, and connect the charger cable to it.

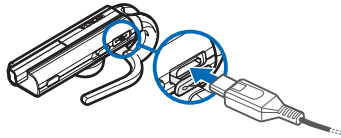

The red indicator light is displayed during charging.

Charging the battery fully may take up to 35 minutes with the AC-6 charger. Charging the battery with the AC-6 charger for 15 minutes provides up to 5 hours of talk time.

3. When the battery is fully charged, the green indicator light is displayed. Disconnect the charger from the headset, then from the wall outlet. Push the cover over the charger connector.

To charge the headset with a compatible Nokia charger that has a 2.0 or 3.5 mm charger plug, use the Nokia Charger Adapter CA-146C (sold separately).

The battery can also be charged through the USB port of a compatible PC using the Nokia Connectivity Cable CA-101 (sold separately). Connect one end of the cable to the charger connector and the other end to the USB port on the PC.

The fully charged battery has power for up to 8 hours of talk time or up to 160 hours of standby time.

To check the battery charge when the headset is not connected to a charger, briefly press the power key when the headset is switched on. If the indicator light is green, the charge level is sufficient. If the light is yellow, you may need to recharge the battery soon. If the light is red, recharge the battery.

When the battery is discharged, the headset beeps about every 5 minutes, and the red indicator light flashes once after any other indicator light.

■ Switch the headset on or off

To switch on, press and hold the power key for about 2 seconds. The headset beeps, and the green indicator light is displayed. The headset

tries to connect to one or two last connected devices. When the headset is connected to a device and is ready for use, the blue indicator light flashes slowly. If the headset has not been paired with a device, it automatically enters the pairing mode (see "Pair and connect the headset", p. 8).

To switch off, press and hold the power key for about 2 seconds. The headset beeps, and the red indicator light is briefly displayed. If the headset is not connected to a device within 30 minutes, it switches off automatically.

■ Pair and connect the headset

You can pair the headset with up to eight devices, but you can connect it to only up to two devices at a time.

1. Ensure that your mobile device is on and the headset is off.
2. To pair the headset if it has not been previously paired with a device, switch on the headset. The headset enters the pairing mode, and the blue indicator light starts to flash quickly.

To pair the headset if it has been previously paired with another device, ensure that the headset is switched off, and press and hold the power key for about 5 seconds until the blue indicator light starts to flash quickly.

3. Activate the Bluetooth feature on your device, and set it to search for Bluetooth devices. For details, see the user guide of your device.
4. Select the headset (Nokia BH-904) from the list of found devices.
5. If your device asks for a Bluetooth passcode, enter **0000** to pair and connect the headset to the device. In some devices, you may need to make the connection separately after pairing. For details, see the user guide of your device.

If pairing is successful, the headset appears in the menu of the mobile device where you can view the currently paired Bluetooth devices.

When the headset is connected to at least one device and is ready for use, the blue indicator light flashes slowly.

Disconnect the headset

To disconnect the headset from your mobile device, switch off the headset, or disconnect it in the Bluetooth menu of the device.

You do not need to delete pairing with the headset to disconnect it.

Reconnect the headset

When you switch on the headset, it tries to connect to one or two devices that you have paired with it, starting from the most recently used ones. See also "Connect the headset to two devices", p. 12.

To manually connect the devices to the headset, press and hold the answer/end key for about 2 seconds (when no devices are connected), or make the connection in the Bluetooth menu of the desired device.

If you have a device connected to the headset and want to connect a second device, make the connection in the Bluetooth menu of the device.

You may be able to set your mobile device so that the headset connects to it automatically. To activate this feature in a Nokia device, change the paired device settings in the Bluetooth menu.

■ Troubleshooting

If you cannot connect the headset to your mobile device, ensure the following:

- The headset is charged, switched on, and paired with your device.
- The Bluetooth feature is activated on your device.
- The headset is within 10 meters (33 feet) of your device and that there are no obstructions between the headset and the device, such as walls, or other electronic devices.

3. Basic use

■ Change the earplug

The headset may be provided with different sized earplugs. Select the earplug that fits best and feels comfortable for your ear.

To change the earplug, pull the current earplug from the earpiece (1), and push the new earplug over the earpiece in the same position (2).

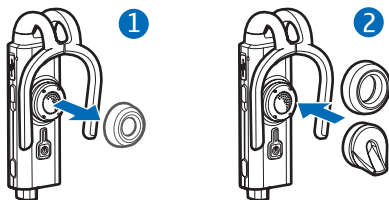

■ Place the headset on the ear

Place the headset over your ear in a comfortable position, and slide it downwards. Gently push the earpiece into your ear. Point the headset toward your mouth.

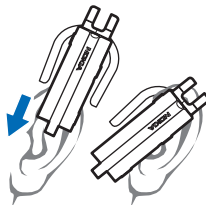

■ Sliding boom

The sliding boom brings the microphone closer to your mouth, which improves the audio quality when you talk at a lower volume or in a noisy environment. You can use the boom to answer or end a call.

To use the boom, gently pull it down toward your mouth (1), or push it up to its initial position (2).

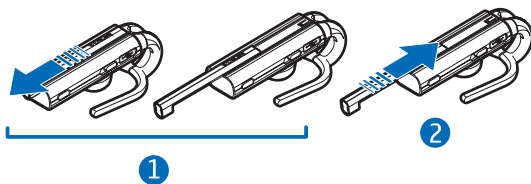

■ Calls

To make a call, use your mobile device in the normal way when the headset is connected to it.

To redial the number you last called (if your mobile device supports this feature with the headset), when no call is in progress, press the answer/end key twice.

To activate voice dialling (if your mobile device supports this feature with the headset), when no call is in progress, press and hold the answer/end key for about 2 seconds until the mobile device starts voice dialling, and proceed as described in the user guide of the device.

To answer a call, pull the boom completely down toward your mouth, or press the answer/end key. (For noise cancellation, the boom has to be completely pulled down.) To reject a call, press the answer/end key twice.

To end a call, push the boom up to its initial position, or press the answer/end key.

■ Adjust the headset volume

The headset automatically adjusts the volume according to ambient noise. Slide the volume key up to increase or down to decrease the volume. To adjust the volume quickly, slide and hold the key.

The selected volume level is saved for the device that you currently use with the headset.

■ Mute or unmute the microphone

To mute the microphone, slide the mute key toward your mouth. To unmute the microphone, slide the mute key to the opposite direction. When you mute or unmute the microphone, the headset beeps twice.

■ Switch a call between headset and mobile device

To switch a call between the headset and a connected device, press and hold the answer/end key for about 2 seconds, or use the respective function in your device.

■ Connect the headset to two devices

You can have the headset connected to two devices at the same time. To pair and connect the headset to two devices, see "Pair and connect the headset", p. 8, and "Reconnect the headset", p. 9.

By default, the headset can only be connected to one device at a time. To allow the headset to connect to two devices at the same time, switch off the headset, and press and hold the power key and the volume up key for about 5 seconds. The blue indicator light flashes twice.

To allow the headset to connect to only one device at a time, switch off the headset, and press and hold the power key and the volume down key for about 5 seconds. The green indicator light flashes twice.

If the headset can connect to two devices at the same time and you use redialling or voice dialling, the call is made on the device that you last used to make a call when the headset was connected to it. When you make or answer a call, the other connected device is disconnected until the call ends.

■ Clear settings or reset

To clear all the pairing settings from the headset, switch off the headset, and press and hold the power key and the answer/end key at the same time for about 5 seconds. The headset beeps twice, and the red and green indicator lights alternate. After the settings are cleared, the headset enters the pairing mode.

To reset the headset if it stops functioning, even though it is charged, connect the headset to a charger, and press the power key and the answer/end key at the same time. The reset does not clear the pairing settings.

4. Battery and charger information

This device has an internal, nonremovable, rechargeable battery. Do not attempt to remove the battery from the device as you may damage the device. This device is intended for use when supplied with power from the following chargers: AC-6 and DC-6. The exact charger model number may vary depending on the type of plug. The plug variant is identified by one of the following: E, EB, X, AR, U, A, C, or UB. The battery can be charged and discharged hundreds of times, but it will eventually wear out. Recharge your battery only with Nokia approved chargers designated for this device. Use of an unapproved charger may present a risk of fire, explosion, leakage, or other hazard.

If a battery is being used for the first time or if the battery has not been used for a prolonged period, it may be necessary to connect the charger, then disconnect and reconnect it to begin charging the battery. If the battery is completely discharged, it may take several minutes before the charging indicator light is displayed.

Unplug the charger from the electrical plug and the device when not in use. Do not leave a fully charged battery connected to a charger, since overcharging may shorten its lifetime. If left unused, a fully charged battery will lose its charge over time.

Always try to keep the battery between 15°C and 25°C (59°F and 77°F). Extreme temperatures reduce the capacity and lifetime of the battery. A device with a hot or cold battery may not work temporarily. Battery performance is particularly limited in temperatures well below freezing.

Do not dispose of batteries in a fire as they may explode. Batteries may also explode if damaged.

Never use any charger that is damaged.



Important: Battery talk and standby times are estimates only and depend on network conditions, features used, battery age and condition, temperatures to which battery is exposed, and many other factors. The amount of time a device is used for calls will affect its standby time. Likewise, the amount of time that the device is turned on and in the standby mode will affect its talk time.

Care and maintenance

Your device is a product of superior design and craftsmanship and should be treated with care. The following suggestions will help you protect your warranty coverage.

- Keep the device dry. Precipitation, humidity, and all types of liquids or moisture can contain minerals that will corrode electronic circuits. If your device does get wet, allow it to dry completely.
- Do not use or store the device in dusty, dirty areas. Its moving parts and electronic components can be damaged.
- Do not store the device in hot areas. High temperatures can shorten the life of electronic devices, damage batteries, and warp or melt certain plastics.
- Do not store the device in cold areas. When the device returns to its normal temperature, moisture can form inside the device and damage electronic circuit boards.
- Do not attempt to open the device.
- Do not drop, knock, or shake the device. Rough handling can break internal circuit boards and fine mechanics.
- Do not use harsh chemicals, cleaning solvents, or strong detergents to clean the device.
- Do not paint the device. Paint can clog the moving parts and prevent proper operation.

These suggestions apply equally to your device, charger, or any accessory. If any device is not working properly, take it to the nearest authorised service facility for service.



Disposal

The crossed-out wheeled-bin symbol on your product, literature, or packaging reminds you that all electrical and electronic products, batteries, and accumulators must be taken to separate collection at the end of their working life. This requirement applies to the European Union and other locations where separate collection systems are available. Do not dispose of these products as unsorted municipal waste.

By returning the products to collection you help prevent uncontrolled waste disposal and promote the reuse of material resources. More detailed information is available from the product retailer, local waste authorities, national producer responsibility organisations, or your local Nokia representative. For the product

Care and maintenance

Eco-Declaration or instructions for returning your obsolete product, go to country-specific information at www.nokia.com.