

# **OLYMPUS<sup>®</sup>**

DIGITAL CAMERA

## ***STYLUS-550WP / $\mu$ -550WP***

### **Instruction Manual**

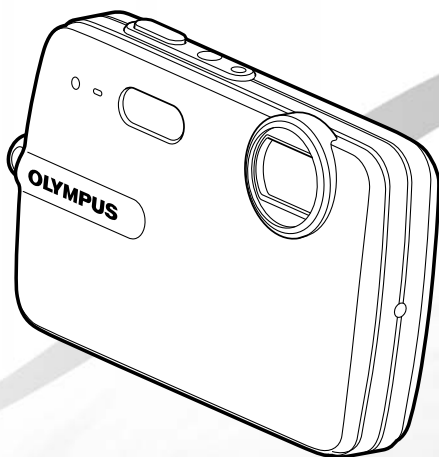

- Thank you for purchasing an Olympus digital camera. Before you start to use your new camera, please read these instructions carefully to enjoy optimum performance and a longer service life. Keep this manual in a safe place for future reference.
- We recommend that you take test shots to get accustomed to your camera before taking important photographs.
- In the interest of continually improving products, Olympus reserves the right to update or modify information contained in this manual.
- The screen and camera illustrations shown in this manual were produced during the development stages and may differ from the actual product.

## Step 1

### Checking the contents of the box



Digital camera



Strap



LI-42B Lithium Ion Battery

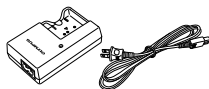

LI-41C Battery Charger



USB cable



AV cable



OLYMPUS Master 2  
CD-ROM



microSD Attachment

Other accessories not shown: Instruction Manual (this manual), warranty card.  
Contents may vary depending on purchase location.

## Step 2

### Preparing the Camera

"Preparing the Camera" (p. 10)

## Step 3

### Shooting and Playing Back Images

"Shooting, Playback, and Erasing" (p. 14)

## Step 4

### How to Use the Camera

"Three Types of Setting Operations" (p. 3)

## Step 5

### Printing

"Direct printing (PictBridge)" (p. 34)

"Print Reservations (DPOF)" (p. 37)

## Contents

- **Names of Parts** .....6
- **Menus for Playback, Editing, and Printing Functions**.....28
- **Preparing the Camera** .....10
- **Menus for Other Camera Settings** .....31
- **Shooting, Playback, and Erasing**.....14
- **Printing**.....34
- **Using Shooting Modes**.....17
- **Using OLYMPUS Master 2**.....40
- **Using Shooting Functions**.....20
- **Usage Tips** .....42
- **Using Playback Features** .....23
- **Appendix** .....46
- **Menus for Shooting Functions**.....24
- **Index** .....59

## Three Types of Setting Operations

### Using the Menu

Various camera settings can be accessed through the menus, including functions used during shooting and playback and the date/time and screen display.

- There may be unavailable menus depending on the other related settings or the selected shooting mode (p. 17).

#### 1 Press the **MENU** button.

- This example describes how to set the [DIGITAL ZOOM].

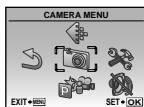

Shooting mode top menu

#### 2 Use **Left Arrow**, **Right Arrow**, **Up Arrow**, and **Down Arrow** to select the desired menu, and press the **OK** button.

- Pressing and holding the **OK** button displays an explanation (menu guide) of the selected option.

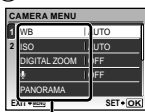

Submenu 1

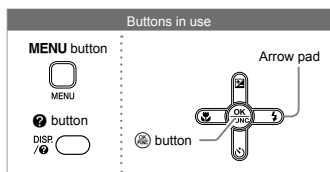

#### 3 Use **Left Arrow** and **Right Arrow** to select the desired submenu 1, and press the **OK** button.

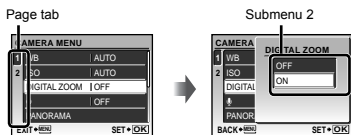

- To quickly move to the desired submenu, press **Left Arrow** to highlight the page tab, and then use **Left Arrow** and **Right Arrow** to move the page tab. Press **Right Arrow** to return to the submenu 1.

- Some menu include submenus that appear by pressing the **OK** button.

#### 4 Use **Left Arrow** and **Right Arrow** to select the submenu 2, and press the **OK** button.

- Once a setting is made, the display returns to the previous screen.

- There may be additional operations. "Menu Settings" (p. 24 to 33)

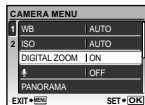

#### 5 Press the **MENU** button to complete the setting.

## Using the Direct Buttons

Frequently used shooting functions can be accessed using the direct buttons.



Shutter button (p. 14)



Zoom button (p. 20, p. 23)



DISP button (changing information display/  
menu guide) (p. 3, p. 22, p. 23)



Exposure compensation button (p. 21)

Macro button (p. 21)

Flash button (p. 20)

Self-timer button (p. 21)



Camera button (shooting/switching shooting modes)  
(p. 14)

Playback button (p. 15)

Backlight boost/erase button (p. 16, p. 22)

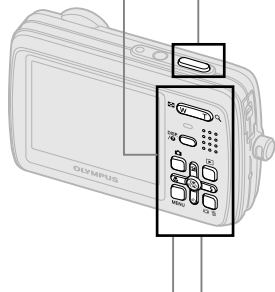

## Using the FUNC Menu (p. 22)

Frequently used shooting menu functions can be set with less steps using the FUNC menu.

FUNC button (p. 3, p. 22)

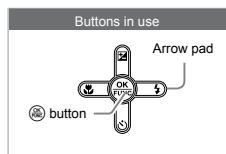

# Menu Index

## Menus for Shooting Functions

Settings can be adjusted, when a shooting mode is selected.

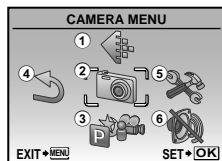

Shooting mode top menu

- |   |  |
|---|--|
| <ul style="list-style-type: none"> <li>①  IMAGE QUALITY ..... p.24</li> <li>②  CAMERA MENU           <ul style="list-style-type: none"> <li>WB ..... p.25</li> <li>ISO ..... p.25</li> <li>DIGITAL ZOOM ..... p.25</li> <li> (still pictures/movies) ..... p.26</li> <li>PANORAMA ..... p.26</li> <li>FACE DETECT ..... p.27</li> </ul> </li> </ul> | <ul style="list-style-type: none"> <li>③  SWITCH SHOOTING MODES           <ul style="list-style-type: none"> <li><b>P</b> ..... p.14</li> <li><b>i</b>AUTO ..... p.17</li> <li>DIS MODE ..... p.18</li> <li><b>SCN</b> ..... p.17</li> <li>MOVIE ..... p.18</li> </ul> </li> <li>④  RESET ..... p.27</li> <li>⑤  SETUP           <ul style="list-style-type: none"> <li>MEMORY FORMAT/FORMAT ..... p.31</li> <li>BACKUP ..... p.31</li> <li> (Language) ..... p.31</li> <li>PIXEL MAPPING ..... p.31</li> <li> SAVE SETTINGS ..... p.32</li> <li>MENU COLOR ..... p.32</li> <li>BEEP ..... p.32</li> <li> (Monitor) ..... p.32</li> <li> (Date/time) ..... p.32</li> <li>VIDEO OUT ..... p.33</li> <li>POWER SAVE ..... p.33</li> </ul> </li> <li>⑥  SILENT MODE ..... p.33</li> </ul> |
|---|--|

## Menus for Playback, Editing, and Printing Functions

Settings can be adjusted, when the image is played back by pressing the button.

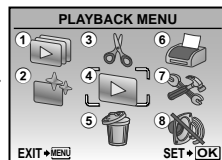

Playback mode top menu

- |   |   |  |
|---|---|--|
| <ul style="list-style-type: none"> <li>①  SLIDESHOW ..... p.28</li> <li>②  PERFECT FIX ..... p.28</li> <li>③  EDIT           <ul style="list-style-type: none"> <li> (Resize) ..... p.28</li> <li> (Crop) ..... p.28</li> </ul> </li> </ul> | <ul style="list-style-type: none"> <li>④  PLAYBACK MENU           <ul style="list-style-type: none"> <li> (Protect) ..... p.29</li> <li> (Rotate) ..... p.29</li> <li> (Add sound to still picture) ..... p.29</li> </ul> </li> </ul> | <ul style="list-style-type: none"> <li>⑤  ERASE ..... p.30</li> <li>⑥  PRINT ORDER ..... p.30</li> <li>⑦  SETUP           <ul style="list-style-type: none"> <li>*Same as "Menus for shooting functions"</li> </ul> </li> <li>⑧  SILENT MODE ..... p.33</li> </ul> |
|---|---|--|



# Names of Parts

## Camera unit

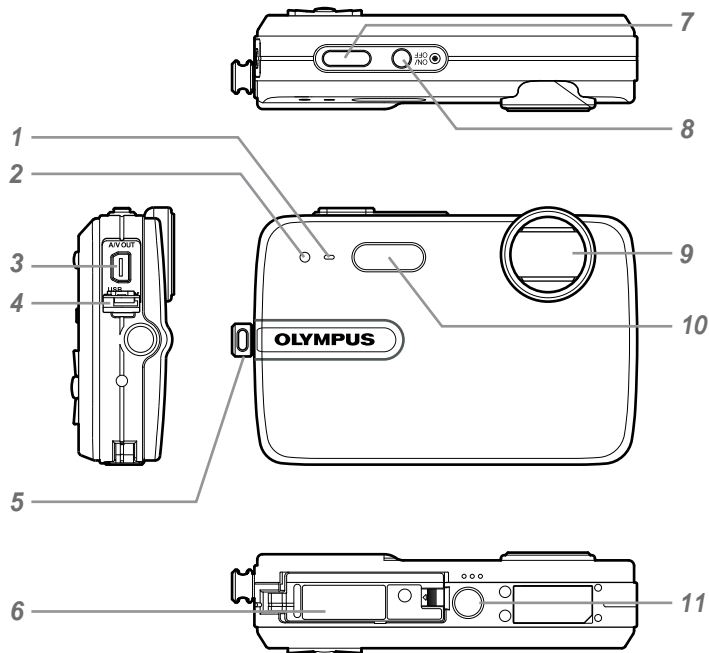

- |   |   |                   |    |                            |           |
|---|---|-------------------|----|----------------------------|-----------|
| 1 | Microphone .....                        | p. 26, 29         | 7  | Shutter button .....       | p. 14, 42 |
| 2 | Self-timer lamp.....                    | p. 21             | 8  | <b>ON/OFF</b> button ..... | p. 13, 14 |
| 3 | Multi-connector .....                   | p. 33, 34, 40     | 9  | Lens .....                 | p. 46     |
| 4 | Connector cover .....                   | p. 33, 34, 40, 51 | 10 | Flash .....                | p. 20     |
| 5 | Strap eyelet.....                       | p. 10             | 11 | Tripod socket .....        | —         |
| 6 | Battery/card compartment cover<br>..... | p. 11, 43, 51     |    |                            |           |

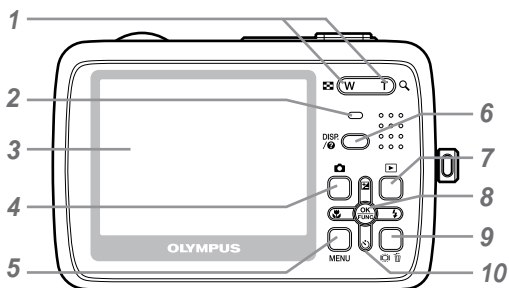

- |  |   |
|--|---|
| <p>1 Zoom button..... p. 20, 23</p> <p>2 Card access lamp ..... p. 48</p> <p>3 Monitor ..... p. 8, 14, 32, 43</p> <p>4  button (shooting/switching shooting modes)..... p. 14</p> <p>5 <b>MENU</b> button..... p. 3, 5</p> <p>6 <b>DISP./</b> button (changing information display/menu guide)..... p. 3, 22, 23</p> <p>7  button (playback) ..... p. 15</p> | <p>8  button (OK/FUNC)..... p. 3, 22</p> <p>9  button (backlight boost/erase) ..... p. 16, 22</p> <p>10 Arrow pad ..... p. 3, 4, 12</p> <p> button (exposure compensation) ..... p. 21</p> <p> button (macro) ..... p. 21</p> <p> button (self-timer) ..... p. 21</p> <p> button (flash)..... p. 20</p> |
|--|---|

Shooting mode display

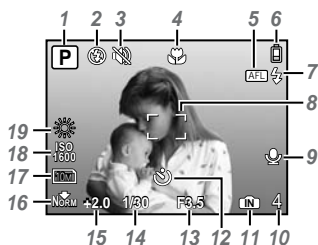

Still image

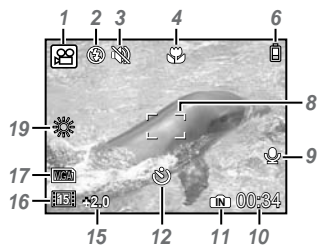

Movie

- 1 Shooting mode..... p. 17, 18
- 2 Flash mode ..... p. 20
- 3 Silent mode..... p. 33
- 4 Macro/super macro..... p. 21
- 5 AF lock..... p. 18
- 6 Battery check..... p. 10, 43
- 7 Flash standby/  
camera shake warning/  
flash charge ..... p. 42
- 8 AF target mark..... p. 14
- 9 Recording with sound ..... p. 26

- 10 Number of storable still pictures/  
remaining recording time  
..... p. 14, 19, 48
- 11 Current memory..... p. 47
- 12 Self-timer ..... p. 21
- 13 Aperture value ..... p. 14
- 14 Shutter speed ..... p. 14
- 15 Exposure compensation ..... p. 21
- 16 Compression/frame rate ..... p. 24
- 17 Image size ..... p. 24
- 18 ISO..... p. 25
- 19 White balance ..... p. 25



## Playback mode display

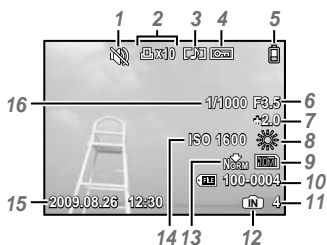

Still image

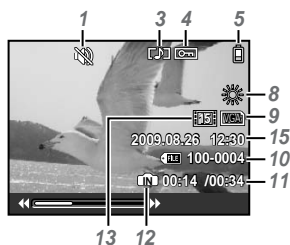

Movie

1	Silent mode.....	p. 33
2	Print reservation/ number of prints.....	p. 37
3	Recording with sound .....	p. 26, 29, 45
4	Protect .....	p. 29
5	Battery check.....	p. 10, 43
6	Aperture value .....	p. 14
7	Exposure compensation .....	p. 21
8	White balance.....	p. 25

9	Image size .....	p. 24
10	File number .....	—
11	Frame number/elapsed time/ total recording time .....	p. 15
12	Current memory.....	p. 47
13	Compression/frame rate .....	p. 24
14	ISO.....	p. 25
15	Date and time .....	p. 13, 32
16	Shutter speed .....	p. 14



# Preparing the Camera

## Attaching the camera strap

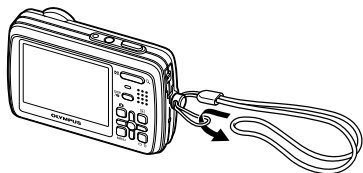

- ⚠ Pull the strap tight so that it does not come loose.

## Charging the battery

- ⚠ The battery charger included (AC cable or plug-in type) differs depending on the region where you purchased the camera. If you received a plug-in type battery charger, plug it directly into an AC outlet.

### Example: AC cable type battery charger

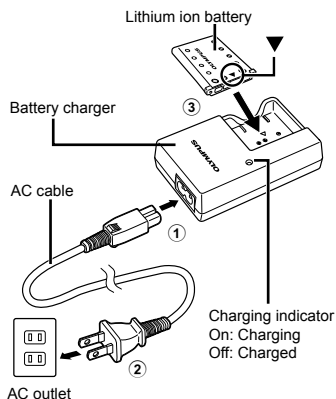

- ⚠ Battery comes partially charged. Before use, be sure to charge the battery until the charging indicator goes off (for approx. 2 hours).
- ⚠ If the charge indicator does not light or it blinks, the battery may not be inserted correctly or the battery or the charger may be broken.
- ⚠ For details on the battery and the charger, see "Battery and charger" (p. 46).

### When to charge the battery

Charge the battery when the error message shown below appears.

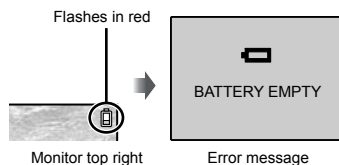

## Loading the battery and the xD-Picture Card™ (sold separately) into the camera

- ❗ Do not insert anything other than an xD-Picture Card or the microSD Attachment into the camera.

1

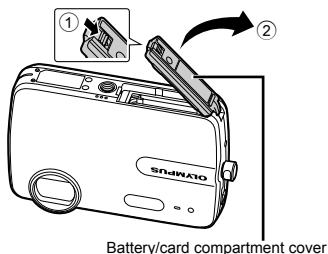

2

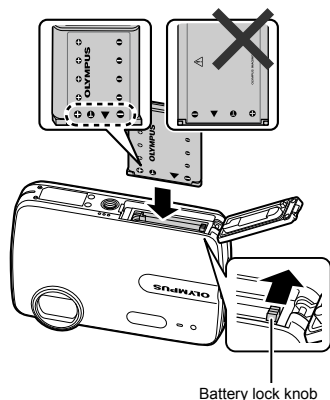

- ❗ Insert the battery by putting in the ▼ marked side first, with the ⚡ marks toward the battery lock knob.
- ❗ Insert the battery while sliding the battery lock knob in the direction of the arrow.
- ❗ To remove the battery, unlock the battery lock knob by sliding it in the direction of the arrow.
- ❗ Turn off the camera before opening or closing the battery/card compartment cover.

3

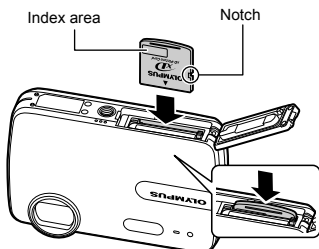

- ❗ Insert the card straight until it clicks into place.
- ❗ Do not touch the contact area on the card.

4

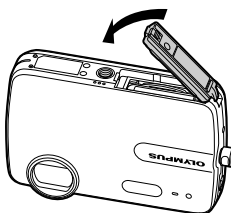

- ❗ This camera allows the user to take pictures using the internal memory even when no xD-Picture Card (sold separately) is inserted. "Using an xD-Picture Card" (p. 47)
- ❗ "Number of storable pictures (still pictures)/ continuous recording length (movies) in the internal memory and xD-Picture card" (p. 48)

## To remove the xD-Picture Card

1



2

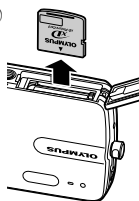

- ❗ Press the card in until it clicks and comes out slightly, and then grasp the card to pull it out.

## Using a microSD card/ microSDHC card (sold separately)

A microSD card/microSDHC card (hereinafter both will be referred to as "the microSD card") is also compatible with this camera using the microSD Attachment.

 "Using a microSD Attachment" (p. 49)

### 1 Insert the microSD card into the Attachment.

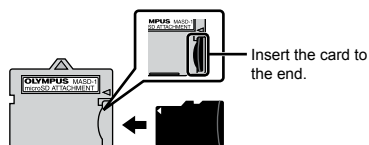

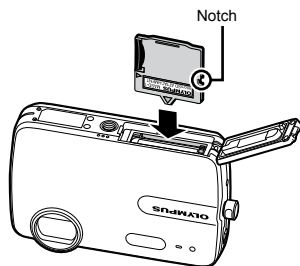

### 2 Insert the microSD Attachment into the camera.

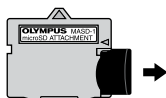

### To remove the microSD card



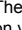
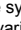
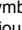
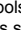

-  Pull the microSD card straight out.
-  Do not touch the contact area on the microSD Attachment and/or microSD card.

## Arrow pad and operation guide

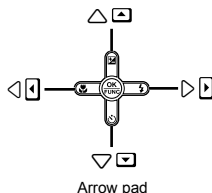
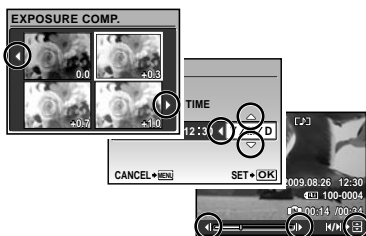
The symbols     displayed on various setting and movie playback screens indicate that the arrow pad is to be used.



Operation guides displayed at the bottom of the screen indicate that the **MENU** button,  button, zoom button, or  button is to be used.

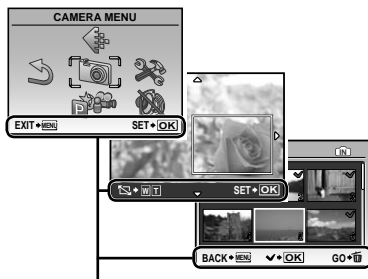

Operation guide

## Setting the date and time

The date and time set here are saved to image file names, date prints, and other data.

- 1 Press the **ON/OFF** button to turn on the camera.

- The date and time setting screen is displayed when the date and time are not set.

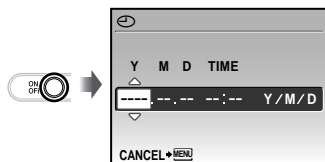

Date and time setting screen

- 2 Use **MEMU** to select the year for [Y].

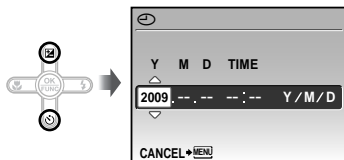

- 3 Press the **OK/FUNC** button to save the setting for [Y].

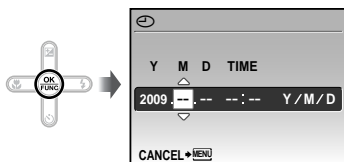

- 4 As in steps 2 and 3, use **MEMU** and the **OK/FUNC** button to set [M] (month), [D] (day), [TIME] (hours and minutes), and [Y/M/D] (date order).

- For a precise time setting, press the **OK/FUNC** button as the time signal strikes 00 seconds.
- To change the date and time, adjust the setting from the menu. [D] (Date/time) (p. 32)

## Changing the display language

The language for the menu and error messages displayed on the monitor is selectable.

- 1 Press the **MENU** button, and press **MEMU** to select [SETUP].

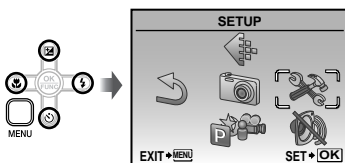

- 2 Press the **OK/FUNC** button.

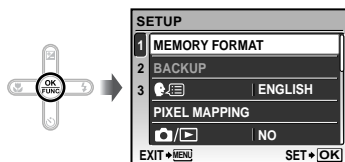

- 3 Use **MEMU** to select [ENGLISH] and press the **OK/FUNC** button.



- 4 Use **MEMU** to select your language and press the **OK/FUNC** button.

- 5 Press the **MENU** button.



# Shooting, Playback, and Erasing

## Shooting with optimum aperture value and shutter speed (P mode)

In this mode, automatic camera shooting can be used while also allowing changes to a wide range of other shooting menu functions, such as exposure compensation, white balance and so on as needed.

For details on the functions that can be adjusted, see "Menus for Shooting Functions" on page 24.

### 1 Press the ON/OFF button to turn on the camera.

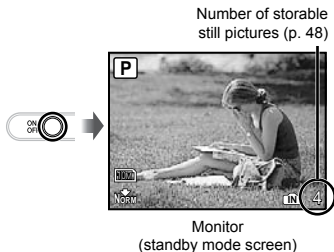

- ❗ If **P** mode is not displayed, press the button a few times to select it.
- ❗ Press the **ON/OFF** button again to turn off the camera.

### 2 Hold the camera, and compose the shot.

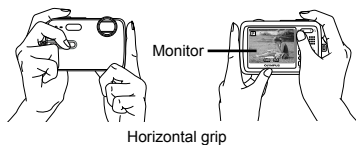

### 3 Press the shutter button halfway down to focus on the subject.

- When the camera focuses on the subject, the exposure is locked (shutter speed and aperture value are displayed), and the AF target mark changes to green.
- The camera was unable to focus if the AF target mark flashes red. Try focusing again.

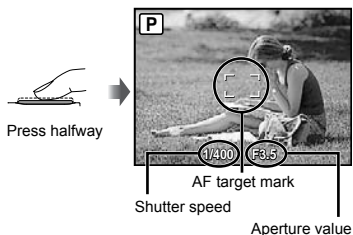

- ❗ "Focusing" (p. 44)

- 4 To take the picture, gently press the shutter button all the way down while being careful not to shake the camera.

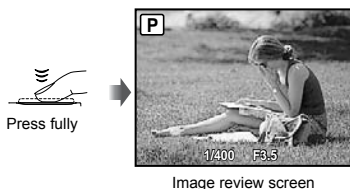

### To view images during shooting

Pressing the button enables playback of images. To return to shooting, either press the button or press the shutter button halfway down.

### To shoot movies

"Shooting movies ( mode)" (p. 18)

## Viewing images

- 1 Press the button.

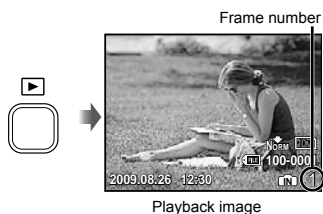

- 2 Use to select an image.

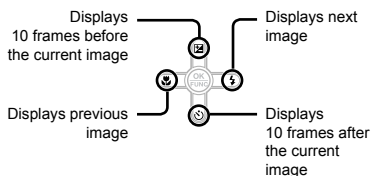

- The display size of the images can be changed. "Index view and close-up view" (p. 23)

### To play back movies

Select a movie, and press the button.



Movie

- The sound recorded in movies cannot be played back on this camera. To play back movies with sound, connect to a TV or PC.

### Operations during movie playback

Fast-forward: While is pressed, the movie is fast-forwarded.

Rewind: While is pressed, the movie is rewound.

Pause: Press the button.



During playback

First (last) frame/frame advance: During pause, press to display the first frame, and press to display the last frame. Playback is reversed while is pressed, playback occurs normally while is pressed. Press the button to resume playback.



### To stop movie playback

Press the MENU button.

*Erasing images during playback (Single image erase)*

---

- 1 Press the  button when the playback image to be erased is displayed.



- 2 Press  to select [YES], and press the  button.

 [ ] (ERASE) (p. 30)





# Using Shooting Modes

The shooting mode changes in the order of **P**, **iAUTO**, **(M)**, **SCN**, **(S)** each time the **(S)** button is pressed. By switching to other shooting mode, most settings set in other than **P** mode will be changed to the default settings of the respective shooting mode.

## Shooting with automatic settings (**iAUTO** mode)

According to the scene, the camera automatically selects the optimal shootings mode from [PORTRAIT]/[LANDSCAPE]/[NIGHT+PORTRAIT]/[SPORT]/[MACRO]. This is a fully automatic mode that allows the user to take pictures using the best mode for the shooting scene simply by pressing the shutter button. The settings in [CAM] (CAMERA MENU) are not available in **iAUTO** mode.

- 1 Press the **(S)** button a few times to set **iAUTO**.

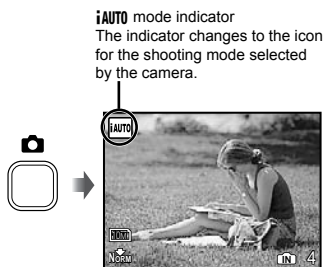

- Press the shutter button halfway down or press the **DISP.** button to check which shooting mode the camera has automatically selected.
- ! In some cases, the camera may not select the desired shooting mode.
- ! When the camera cannot identify which is the optimal mode, **P** mode will be selected.

## Using the best mode for the shooting scene (**SCN** mode)

- 1 Press the **(S)** button a few times to set **SCN**.



- An explanation of the selected mode is displayed while the **(S)** button is pressed and held.

- 2 Use **(M)**/**(S)** to select the best shooting mode for the scene, and press the **(S)** button.

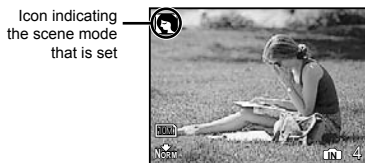

- ! In **SCN** mode, the optimum shooting settings are pre-programmed for specific shooting scenes. For this reason, settings may not be changed in some modes.
- ! To change to another scene mode, use the menu. [**DISP.**] SWITCH SHOOTING MODES (p. 27)

Submenu 1	Application
PORTRAIT/ LANDSCAPE/ NIGHT SCENE <sup>1)</sup> / NIGHT+PORTRAIT/ SPORT/ INDOOR/ CANDLE <sup>1)</sup> / SELF PORTRAIT/ SUNSET <sup>1)</sup> / FIREWORKS <sup>1)</sup> / CUISINE/ DOCUMENTS/ UNDERWATER SNAPSHOT	The camera takes a picture in the mode for the shooting scene.

<sup>1)</sup> When the subject is dark, noise reduction is automatically activated. This approximately doubles the shooting time, during which no other pictures can be taken.

### To take underwater photos

Select [UNDERWATER SNAPSHOT].

! "Important information about water resistant feature" (p. 49)

### To lock the focus distance for an underwater shot (AF lock)

When [UNDERWATER SNAPSHOT] is selected, press [AF-L].

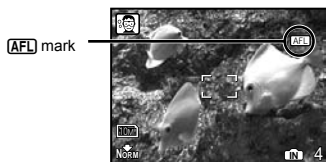

! To cancel, press [AF-L] again to clear the [AF-L] mark.

## Using the digital image stabilization mode (iAS mode)

This mode enables the user to reduce blurring that is caused by a camera shake and subject movement.

1 Press the [CAMERA] button a few times to set [iAS].

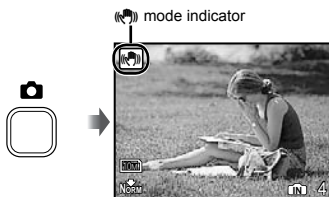

## Shooting movies (MOV mode)

Audio is recorded with the movie.

1 Press the [CAMERA] button a few times to set [MOV].

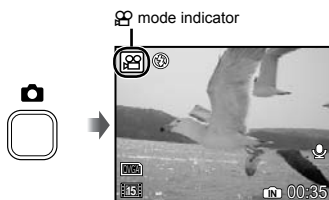

### To zoom while shooting a movie

While recording a movie with sound, only the digital zoom is available. To use the optical zoom, set [ZOOM] (movies) (p. 26) to [OFF].

- 
- 2 Press the shutter button halfway down to focus on the subject, and gently press the button all the way down to start recording.**

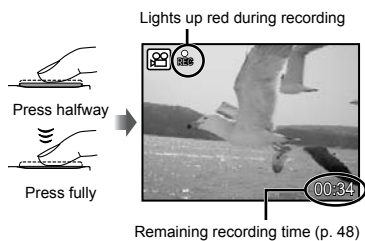

- 
- 3 Gently press the shutter button all the way down to stop recording.**



# Using Shooting Functions

## Using the optical zoom

Pressing the zoom button adjusts the shooting range.

Pressing the wide (W) button      Pressing the telephoto (T) button

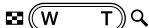

Zoom bar

- Optical zoom: 3.0×, digital zoom: 5.0×.
- Use of mode (p. 18) is recommended when shooting with the telephoto zoom.

### To take larger images

[DIGITAL ZOOM] (p. 25)

- The zoom bar appearance identifies the status of the digital zoom.

When using optical zoom



Optical zoom range

When using digital zoom



Digital zoom range

## Using the flash

The flash functions can be selected to best match the shooting conditions and render the desired image.

- Press the button.



- Use to select the setting option, and press the button to set.

Item	Description
FLASH AUTO	The flash fires automatically in low-light or backlight conditions.
REDEYE	Pre-flashes are emitted to reduce the occurrence of red eye in your photos.
FILL IN	The flash fires regardless of the available light.
FLASH OFF	The flash does not fire.

## Adjusting the brightness (Exposure compensation)

The standard brightness (appropriate exposure) set by the camera based on the shooting mode (except for **iAUTO**) can be adjusted brighter or darker to obtain the desired shot.

- 1 Press the button.

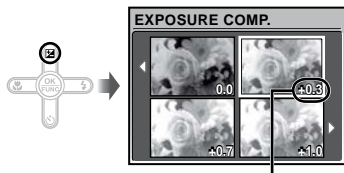

Exposure compensation value

- 2 Use to select the desired brightness image, and press the button.

## Shooting close-ups (Macro shooting)

This function enables the camera to focus and shoot subjects at close distances.

- 1 Press the button.

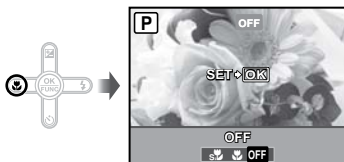

- 2 Use to select the setting option, and press the button to set.

Item	Description
OFF	Macro mode is deactivated.
MACRO	This enables shooting as close as 20 cm/7.9 in. <sup>*1</sup> (30 cm/11.8 in. <sup>*2</sup> ) to the subject.
SUPER MACRO <sup>*3</sup>	This enables shooting as close as 7 cm/2.8 in. to the subject.

<sup>\*1</sup> When the zoom is at the widest (W) position.

<sup>\*2</sup> When the zoom is at the most telephoto (T) position.

<sup>\*3</sup> The zoom is automatically fixed.

The flash (p. 20) and zoom (p. 20) cannot be set during super macro shooting.

## Using the self-timer

After the shutter button is pressed all the way down, the picture is taken after a time delay.

- 1 Press the button.



- 2 Use to select the setting option, and press the button to set.

Item	Description
OFF	This cancels the self-timer.
ON	The self-timer lamp turns on for approx. 10 seconds, and then blinks for approx. 2 seconds, and then the picture is taken.

Self-timer shooting is automatically canceled after one shot.

**To cancel the self-timer after it starts**  
Press the button again.

## Increasing the brightness of the monitor (Backlight boost)

Press the  button in shooting mode. The monitor becomes brighter. If there is no operation for 10 seconds, the previous brightness resumes.

## Changing the shooting information display

The display of the screen information can be changed to best match the situation, such as for the need of clear view of the screen or for making a precise composition by using the grid display.

### 1 Press the DISP. button.

- The displayed shooting information changes in the order shown below each time the button is pressed. "Shooting mode display" (p. 8)

Normal



No information



Grid



## Using the FUNC menu

The FUNC menu provides the following menu functions that can be quickly accessed and set.

- [WB] (p. 25)
- [ISO] (p. 25)
- [Q] (IMAGE QUALITY) (p. 24)

### 1 Press the button.

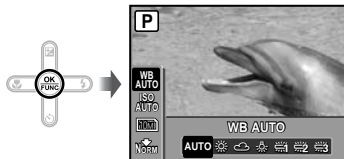

### 2 Use to select the menu function and to select the setting option, and then press the button to set.

# Using Playback Features

## Index view and close-up view

Index view enables quick selection of a desired image. Close-up view (up to 10x magnification) allows checking of image details.

### 1 Press the zoom button.

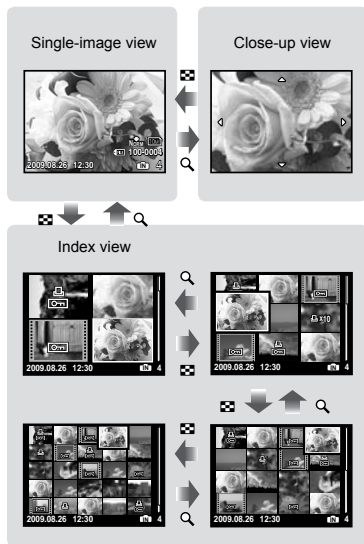
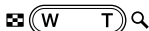

#### To select an image in index view

Use to select an image, and press the button to display the selected image in single-image view.

#### To scroll an image in close-up view

Use to move the viewing area.

## Changing the image information display

The set of shooting information displayed on the screen can be changed.

### 1 Press the DISP. button.

- The displayed image information changes in the order shown below each time the button is pressed.

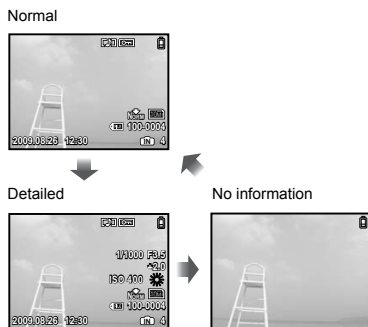

# Menus for Shooting Functions

Settings can be adjusted, when a shooting mode is selected.



indicates the shooting modes at which the function can be set.



The default settings of the function are highlighted in .

## Selecting the appropriate image quality for your application [◀ IMAGE QUALITY]

◀ IMAGE QUALITY

: P i AUTO SCN

### Still images

Submenu 1	Submenu 2	Application
IMAGE SIZE	10M (3648×2736)	Suitable for printing pictures over A3 (11×17 in.).
	5M (2560×1920)	Suitable for printing pictures at A4 (8.5×11 in.).
	3M (2048×1536)	Suitable for printing pictures up to A4 (8.5×11 in.).
	2M (1600×1200)	Suitable for printing pictures at A5 (5×7 in.).
	1M (1280×960)	Suitable for printing pictures at postcard size.
	VGA (640×480)	Suitable for viewing pictures on a TV or using pictures in emails and on websites.
	16:9 (1920×1080)	Suitable for playing pictures on a wide screen TV.
COMPRESSION	FINE	Shooting at high quality.
	<b>NORMAL</b>	Shooting at normal quality.

### Movies

Submenu 1	Submenu 2	Application
IMAGE SIZE	VGA (640×480) / QVGA (320×240)	Select the image quality based on the image size and frame rate. Higher frame rates provide smoother video images.
FRAME RATE	30 30fps <sup>*1</sup> /  15 15fps <sup>*1</sup>	

<sup>\*1</sup> frames per second



"Number of storable pictures (still pictures)/continuous recording length (movies) in the internal memory and xD-Picture Card" (p. 48)



## Adjusting to a natural color scheme [WB]

CAMERA MENU ► WB

: P SCN

Submenu 2	Application
AUTO	The camera automatically adjusts the white balance according to the shooting scene.
	For shooting outdoors under a clear sky
	For shooting outdoors under a cloudy sky
	For shooting under tungsten lighting
	For shooting under daylight fluorescent lighting (household lighting, etc.)
	For shooting under neutral fluorescent lighting (desk lamps, etc.)
	For shooting under white fluorescent lighting (offices, etc.)

## Selecting the ISO sensitivity [ISO]

CAMERA MENU ► ISO

: P

- ! Abbreviation for the International Organization for Standardization. ISO standards specify the sensitivity for digital cameras and film, thus codes such as "ISO 100" are used to represent sensitivity.
- ! In the ISO setting, although smaller values result in less sensitivity, sharp images can be taken under fully lit conditions. Larger values result in higher sensitivity, and images can be taken at fast shutter speeds even under dimly lit conditions. High sensitivity introduces electrostatic noise into the resulting picture, which may give it a grainy appearance.

Submenu 2	Application
AUTO	The camera automatically adjusts the sensitivity according to the shooting scene.
100/200/400/ 800/1600	The value of the ISO sensitivity is fixed.

## Shooting at higher magnifications than optical zoom [DIGITAL ZOOM]

CAMERA MENU ► DIGITAL ZOOM

: P SCN

Submenu 2	Application
OFF	Only optical zoom is used to zoom in for shooting.
ON	Optical zoom and digital zoom are combined to zoom in for shooting (Approx. 15x (max.)).

- ! This function is not available when [s] SUPER MACRO] (p. 21) is selected.

## Recording sound when shooting still images [🔊]

📷 CAMERA MENU ▶ 🔊

📷 : P 🔊 SCN

Submenu 2	Application
OFF	No sound is recorded.
ON	The camera automatically starts recording for approx. 4 seconds after taking the picture. This is useful for recording notes or comments about the picture.

- ⚠ When recording, aim the microphone (p. 6) at the source of the sound you want to record.
- ⚠ The sound recorded with the still images cannot be played back on this camera. To listen to the sound, connect to a TV or PC.

## Selecting sound setting for movies [🔊]

📷 CAMERA MENU ▶ 🔊

📷 : 🎥

Submenu 2	Application
OFF	No sound is recorded.
ON	Sound is recorded.

- ⚠ While recording a movie with sound, only digital zoom is available. To use the optical zoom, set [🔊] (movies) to [OFF].
- ⚠ The sound recorded with the movies cannot be played back on this camera. To listen to the sound, connect to a TV or PC.

## Creating panoramic images [PANORAMA]

📷 CAMERA MENU ▶ PANORAMA

📷 : P 🔊 SCN

Panorama shooting lets you create a panoramic picture, using the OLYMPUS Master 2 software on the provided CD-ROM.

- ⚠ The focus, exposure (p. 21), zoom position (p. 20), and [WB] (p. 25) are locked at the first frame.
- ⚠ The flash (p. 20) is fixed at [🔇] (FLASH OFF) mode.

- 1 Use [📷] [🔊] [📷] to select the direction that the frames are combined.
- 2 Press the shutter button to take the first frame, and then compose the second shot.
  - Compose the shot using the guide frame so that the two adjacent frames overlap.



- 3 Repeat Step 2 until the number of required frames are taken, and then press the [📷] button when done.
- ⚠ When the [📷] mark is displayed, you cannot continue shooting any further. Panorama shooting is possible for up to 10 frames.
  - ⚠ Refer to the OLYMPUS Master 2 help guide for details on how to make panorama images.

### Selecting the focusing on a face [FACE DETECT]

CAMERA MENU ► FACE DETECT

: P SCN

Submenu 2	Application
OFF	Face detection is not activated.
ON <sup>1</sup>	This is used for taking pictures of people. The camera automatically detects and focuses on a face.

<sup>1</sup> For some subjects, the frame may not appear or may take some time to appear.

### Switching the shooting modes [SWITCH SHOOTING MODES]

SWITCH SHOOTING MODES

: P iAUTO SCN

Submenu 1	Application
<b>P</b>	Shooting with the optimum aperture value and shutter speed (p. 14).
<b>iAUTO</b>	Shooting with automatic settings (p. 17).
DIS MODE	Shooting with digital image stabilization mode (p. 18).
<b>SCN</b>	Using the best mode for the shooting scene (p. 17).
MOVIE	Shooting a movies (p. 18).

### Restoring the shooting functions to the default settings [RESET]

RESET

: P iAUTO SCN

Submenu 1	Application
YES	Restores the following menu functions to the default settings: <ul style="list-style-type: none"> <li>• Flash (p. 20)</li> <li>• Exposure compensation (p. 21)</li> <li>• Macro (p. 21)</li> <li>• Self-timer (p. 21)</li> <li>•  (IMAGE QUALITY) (p. 24)</li> <li>•  (SWITCH SHOOTING MODES) (p. 27)</li> <li>• Menu functions in  (CAMERA MENU) (p. 25 to 27)</li> <li>• Shooting information display (p. 22)</li> </ul>
NO	The current settings are not changed.

# Menus for Playback, Editing, and Printing Functions

Settings can be adjusted, when the image is played back by pressing the button.

## Playing back automatically [ SLIDESHOW]

### SLIDESHOW

#### To start a slideshow

To start the slideshow, press the button.  
To stop the slideshow, press the button or the **MENU** button.

- ❗ During the slideshow, recorded sound cannot be played back on this camera.  
To listen to the sound, connect to a TV or PC.

## Retouching images [ PERFECT FIX]

### PERFECT FIX

- ❗ Edited or retouched images cannot be retouched again.
- ❗ Depending on the picture, the editing may not be effective.
- ❗ The retouching process may lower the image resolution.

Submenu 1	Application
ALL	[LIGHTING FIX] and [REDEYE FIX] are applied together.
LIGHTING FIX	Only sections darkened by backlighting and dim lighting are brightened.
REDEYE FIX	Eyes that are reddened by the flash are corrected.

- ① Use to select a correction method and press the button.
- ② Use to select an image for retouching, and press the button.
  - The retouched image is saved as a separate image.

## Changing the image size []

### EDIT

Submenu 2	Application
VGA 640 × 480	This saves a high-resolution image as a separate image with a smaller size for use in e-mail attachments and other applications.
QVGA 320 × 240	

- ① Use to select an image, and press the button.
- ② Use to select an image size and press the button.
  - The image with the selected size is saved as a separate image.

## Cropping a picture []

### EDIT

- ① Use to select an image, and press the button.
- ② Use the zoom button to select the size of the cropping frame, and use to move the frame.



- ③ Press the button.
  - The edited image is saved as a separate image.

## Protecting images [Oπ]

▶ PLAYBACK MENU ▶ Oπ

- ! Protected images cannot be erased by [ERASE] (p. 16), [SEL. IMAGE], or [ALL ERASE] (p. 30), but all images are erased by [MEMORY FORMAT]/[FORMAT] (p. 31).

Submenu 2	Application
OFF	Images can be erased.
ON	Images are protected so that they cannot be erased except by formatting of the internal memory/card.

- Use to select an image.
- Use to select [ON].
- If necessary, repeat Steps ① and ② to protect other images, and press the button.

## Rotating images [↻]

▶ PLAYBACK MENU ▶ ↻

Submenu 2	Application
+90°	The image is rotated 90° clockwise.
0°	The image is not rotated.
-90°	The image is rotated 90° counter-clockwise.

- Use to select an image.
- Use to select the rotation direction.
- If necessary, repeat Steps ① and ② to make settings for other images, and press the button.

- ! The new picture orientations will be saved even after the power is turned off.

## Adding sound to still images [🗣️]

▶ PLAYBACK MENU ▶ 🗣️

Submenu 2	Application
YES	The camera adds (records) sound for approx. 4 seconds while playing back the image. This is useful for recording notes or comments about the image.
NO	No sound is recorded.

- Use to select an image.
- Aim the microphone toward the sound source.

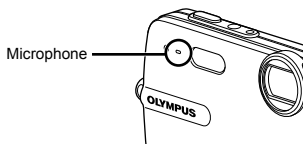

- Use to select [YES], and press the button.
  - Recording starts.

## Erasing images [ERASE]

### ERASE

- Check each picture before erasing to avoid erasing any important pictures you may want to keep.

Submenu 1	Application
SEL. IMAGE	Images are individually selected and erased.
ALL ERASE	All images in the internal memory or card are erased.

- When erasing pictures in the internal memory, do not insert the card into the camera.
- When erasing pictures from the card, insert a card into the camera in advance.

### To individually select and erase images [SEL. IMAGE]

- Use to select [SEL. IMAGE], and press the button.
- Use to select the image to be erased, and press the button to add a ✓ mark to the image.



- Repeat Step ② to select the images to be erased, and then press the button to erase the selected images.
  - Use to select [YES], and press the button.
- The images with a ✓ mark are erased.

### To erase all images [ALL ERASE]

- Use to select [ALL ERASE], and press the button.
- Use to select [YES], and press the button.

## Saving print settings to the image data [PRINT ORDER]

### PRINT ORDER

- "Print Reservations (DPOF)" (p. 37)
- Print reservation can only be set for still images that are recorded to the card.

# Menus for Other Camera Settings

These settings can be adjusted from the shooting mode top menu or playback mode top menu.

## Erasing data completely [MEMORY FORMAT]/[FORMAT]

SETUP ► MEMORY FORMAT/FORMAT

- ! Before formatting, check that no important data is left in the internal memory or card.
- ! Non-Olympus cards and cards that have been formatted by a computer must be formatted with this camera before use.

Submenu 2	Application
YES	Completely erases the image data in the internal memory <sup>1</sup> or card (including protected images).
NO	Cancels formatting.

<sup>1</sup> Be sure to remove the card before formatting the internal memory.

## Copying images in the internal memory to the card [BACKUP]

SETUP ► BACKUP

Submenu 2	Application
YES	Backs up image data in the internal memory to the card.
NO	Cancels the backup.

- ! It takes some time to back up data. Check that the battery has sufficient power before starting the backup, or use an AC adapter.

## Changing the display language [ ]

SETUP ► [ ]

- ! "Changing the display language" (p. 13)

Submenu 2	Application
Languages <sup>1</sup>	The language for the menus and error messages displayed on the monitor is selected.

<sup>1</sup> The available languages vary depending on the country and/or region where the camera was purchased.

## Adjusting the CCD and adjusting the image processing function [PIXEL MAPPING]

SETUP ► PIXEL MAPPING

- ! This function has already been adjusted at factory shipping, and no adjustment is needed right after purchase. Approximately once a year is recommended.
- ! For best results, wait at least one minute after taking or viewing pictures before performing pixel mapping. If the camera is turned off during pixel mapping, be sure to perform it again.



### To adjust the CCD and to adjust the image processing function

Press the  button when [START] (submenu 2) is displayed.

- The camera checks and adjusts the CCD and the image processing function at the same time.

## Using the button or button to turn on the camera [ ]

SETUP ►  

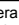
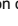
Submenu 2	Application
YES	Pressing  button turns on the camera in shooting mode. Pressing  button turns on the camera in playback mode.
NO	The camera is not turned on when  button or  button is pressed. To turn on the camera, press the ON/OFF button.

## Saving the shooting mode setting when the camera is turned off [SAVE SETTINGS]

SETUP ► SAVE SETTINGS

Submenu 2	Application
YES	The shooting mode is saved when the camera is turned off and is reactivated the next time the camera is turned on.
NO	The shooting mode is set to the <b>P</b> mode when the camera is turned on.

When set to [YES], the following settings will be saved:

- Flash
- Exposure compensation
- White balance
- Digital zoom
- Face detect
- Macro
- ISO
- Recording with sound (Still picture/Movies)

When set to [NO], all shooting settings set in other than **P** mode, [IMAGE QUALITY] and **SCN** mode return to default settings when the camera is turned off.

## Selecting the menu screen color and background [MENU COLOR]

SETUP ► MENU COLOR

Submenu 2	Application
NORMAL/ COLOR 1/ COLOR 2/ COLOR 3	Selects the menu screen color or background image according to your preference.

## Selecting the operation sound [BEEP]

SETUP ► BEEP

Submenu 2	Application
OFF/ON	Selects the operating sound/warning sound of the camera buttons.

To turn off all sounds at once, make the setting from [SILENT MODE] (p. 33).

## Adjusting the brightness of the monitor [MONITOR]

SETUP ► MONITOR

Submenu 2	Application
BRIGHT/ NORMAL	Selects the monitor brightness depending on the surrounding brightness.

## Setting the date and time [DATE/TIME]

SETUP ► DATE/TIME

"Setting the date and time" (p. 13)

### To select the date and time display order

- Press **DATE/TIME** after setting "Minute", and use **DATE/TIME** to select the date display order.

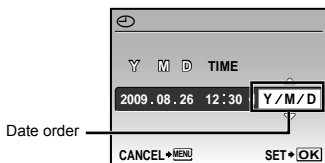



## Selecting the video signal system to match your TV [VIDEO OUT]

### SETUP ► VIDEO OUT

- ⚠ The TV video signal system varies depending on the countries and regions. Before viewing camera images on your TV, select the video output according to your TV's video signal type.

Submenu 2	Application
NTSC	Connecting the camera to a TV in North America, Taiwan, Korea, Japan, and so on
PAL	Connecting the camera to a TV in European countries, China, and so on

- ⚠ The factory default settings differ according to the region where the camera is sold.

### To play back camera images on a TV

- ① Connect the TV and camera.

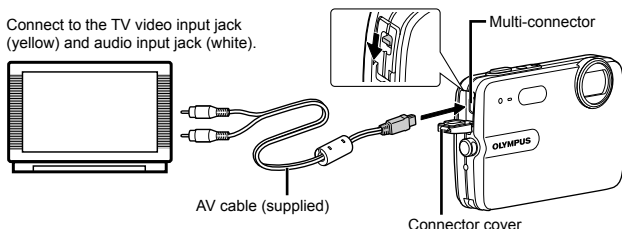

- ② Use the camera to select the same video signal system as the one of connected TV ([NTSC]/[PAL]).
- ③ Turn on the TV, and change "INPUT" to "VIDEO (an input jack connected to the camera)."
- ⚠ For details on changing the input source of the TV, refer to the TV's instruction manual.
- ④ Press the button, and use to select the image for playback.
- ⚠ Depending on the TV's settings, the displayed images and information may become cropped.

## Saving battery power between shots [POWER SAVE]

### SETUP ► POWER SAVE

Submenu 2	Application
OFF	Cancels [POWER SAVE]
ON	When the camera is not being used for approx. 10 seconds, the monitor automatically turns off to save battery power.

### To resume standby mode

Press any button.

## Turning off the camera sounds [SILENT MODE]

### SILENT MODE

Submenu 1	Application
OFF	Button operation sound and warning sound are output.
ON	Button operation sound and warning sound are muted.

- ⚠ [BEEP] (p. 32)

# Printing

## Direct printing (PictBridge<sup>\*1</sup>)

By connecting the camera to a PictBridge-compatible printer, you can print images directly without using a computer.

To find out if your printer supports PictBridge, refer to the printer's instruction manual.

<sup>\*1</sup> PictBridge is a standard for connecting digital cameras and printers of different makers and printing out pictures directly.

- ! The printing modes, paper sizes, and other parameters that can be set with the camera vary depending on the printer that is used. For details, refer to the printer's instruction manual.
- ! For details on the available paper types, loading paper, and installing ink cassettes, refer to the printer's instruction manual.

## Printing images at the printer's standard settings [EASY PRINT]

### 1 Display the image to be printed on the monitor.

- ! "Viewing images" (p. 15)
- ! Printing can also be started when the camera is turned off. After performing Step 2, use to select [EASY PRINT], press the button. Use to select an image, and then press the button to start printing.

### 2 Turn on the printer, and then connect the printer and camera.

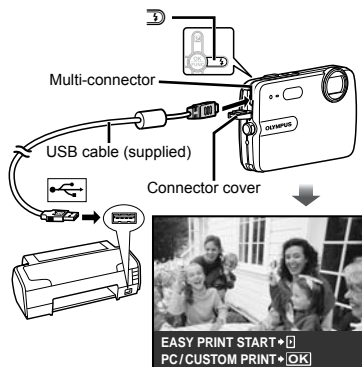

### 3 Press to start printing.

### 4 To print another image, use to select an image, and press the button.

#### To exit printing



After a selected image is displayed on the screen, disconnect the USB cable from the camera and printer.

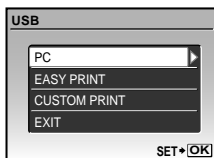

## Changing the printer's settings for printing [CUSTOM PRINT]

- 1 Follow Steps 1 and 2 for [EASY PRINT] (p. 34), then press the  button.



- 2 Use   to select [CUSTOM PRINT], and press the  button.

- 3 Use   to select the print mode, and press the  button.



Submenu 2	Application
PRINT	This prints the image selected in Step 6.
ALL PRINT	This prints all images stored in the internal memory or card.
MULTI PRINT	This prints one image in a multiple layout format.
ALL INDEX	This prints an index of all images stored in the internal memory or card.
PRINT ORDER <sup>1</sup>	This prints images based on the print reservation data on the card.

<sup>1</sup> [PRINT ORDER] is available only when print reservations have been made. "Print Reservations (DPOF)" (p. 37)

- 4 Use   to select [SIZE] (Submenu 3), and press .

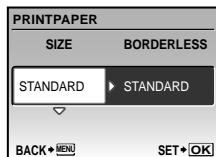
 If the [PRINTPAPER] screen is not displayed, the [SIZE], [BORDERLESS] and [PICS/SHEET] are set to the printer's standard.



- 5 Use   to select the [BORDERLESS] or [PICS/SHEET] settings, and press the .

Submenu 4	Application
OFF/ON <sup>1</sup>	The image is printed with a border around it ([OFF]). The image is printed to fill the entire paper ([ON]).
(The number of images per sheet varies depending on the printer.)	The number of images per sheet ([PICS/SHEET]) is selectable only when [MULTI PRINT] is selected in Step 3.

<sup>1</sup> The available settings for [BORDERLESS] vary depending on the printer.

 If [STANDARD] is selected in Steps 4 and 5, the image is printed at the printer's standard settings.



6 Use to select an image.

7 Press to [SINGLE PRINT] the current image.

Press if you wish to make detailed printer settings for the current image.

To make detailed printer settings

① Use to make the detailed printer settings, and press the button.

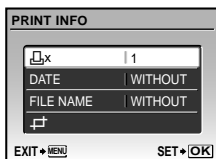

Submenu 5	Submenu 6	Application
	0 to 10	This selects the number of prints.
DATE	WITH/ WITHOUT	Selecting [WITH] prints the images with the date. Selecting [WITHOUT] prints the images without the date.
FILE NAME	WITH/ WITHOUT	Selecting [WITH] prints the file name on the image. Selecting [WITHOUT] does not print any file name on the image.
	(Proceeds to the setting screen.)	This selects a portion of the image for printing.

To crop an image ()

① Use the zoom button to select the size of the cropping frame, use to move the frame, and then press the button.



② Use to select [OK], and press the button.



8 If necessary, repeat Steps 6 to 7 to select the image to be printed, make the detailed settings, and set [SINGLEPRINT].

9 Press the button.

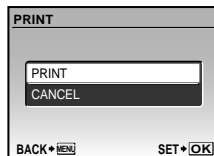

---

10 Use to select [PRINT], and press the button.

- Printing starts.
- When [OPTION SET] is selected in [ALL PRINT] mode, [PRINT INFO] screen is displayed.
- When printing is finished, the [PRINT MODE SELECT] screen is displayed.

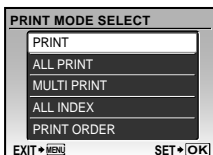

**To cancel printing**

- 1 Press the button while [TRANSFERRING] is displayed.
- 2 Use to select [CANCEL], then press the button.

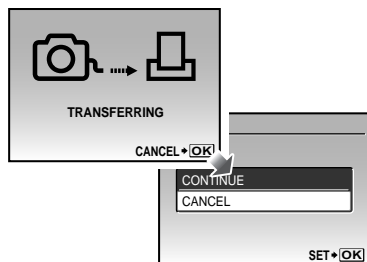

---

11 Press the MENU button.

---

12 When the message [REMOVE USB CABLE] is displayed, disconnect the USB cable from the camera and printer.

---

*Print Reservations (DPOF<sup>\*1</sup>)*

In print reservations, the number of prints and date imprint option are saved in the image on the card. This enables easy printing at a printer or print shop supporting DPOF by using only the print reservations on the card without a computer or a camera.

<sup>\*1</sup> DPOF is a standard for storing automatic printout information from digital cameras.

- ! Print reservations can be set only for the images stored on the card. Insert a card with recorded images before making print reservations.
- ! DPOF reservations set by another DPOF device cannot be changed by this camera. Make changes using the original device. Making new DPOF reservations with this camera will erase the reservations made by the other device.
- ! DPOF print reservations can be made for up to 999 images per card.

---

*Single-frame print reservations*

- 1 Press the button, and then press the MENU button to display the top menu.
- 2 Use to select [PRINT ORDER], and press the button.

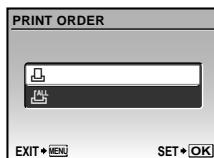

- 3 Use to select [1], and press the button.



- 4 Use to select the image for print reservation. Use to select the quantity. Press the button.



- 5 Use to select the [ ] (date print) screen option, and press the button.

Submenu 2	Application
NO	This prints the image only.
DATE	This prints the image with the shooting date.
TIME	This prints the image with the shooting time.



- 6 Use to select [SET], and press the button.

*Reserving one print each of all images on the card [ALL]*

- 1 Follow Steps 1 and 2 in [ ] (p. 37).
- 2 Use to select [ALL], and press the button.
- 3 Follow Steps 5 to 6 in [ ].

*Resetting all print reservation data*

- 1 Press the button, and then press the MENU button to display the top menu.
- 2 Use to select [PRINT ORDER], and press the button.
- 3 Select either [ ] or [ALL], and press the button.

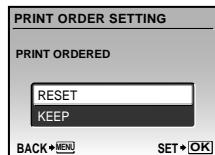





- 4 Use to select [RESET], and press the button.

## *Resetting the print reservation data for selected images*



---

- 1 Follow Steps 1 and 2 of “Resetting all print reservation data” (p. 38).





---

- 2 Use   to select , and press the  button.

---

- 3 Use   to select [KEEP] and press the  button.





---

- 4 Use   to select the image with the print reservation you want to cancel. Use   to set the print quantity to “0”.



---

- 5 If necessary, repeat Step 4, and then press the  button when finished.

---

- 6 Use   to select the  (date print) screen option, and press the  button.
  - The settings are applied to the remaining images with the print reservation data.

---

- 7 Use   to select [SET], and press the  button.

# Using OLYMPUS Master 2

## System requirements and installation of OLYMPUS Master 2

Install the OLYMPUS Master 2 software by referring to the included installation guide.

## Connecting the camera to a computer

### 1 Make sure the camera is turned off.

- The monitor is off.
- The lens cover is closed.

### 2 Connect the camera to a computer.

- The camera automatically turns on.

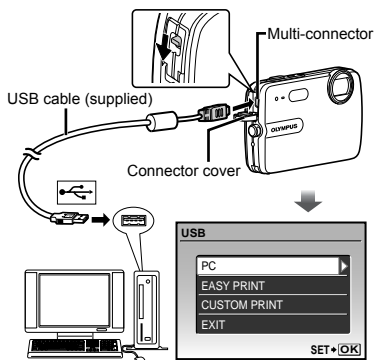

- Locate the position of the USB port by referring to your computer's instructions manual.

### 3 Use to select [PC], and press the button.

- The computer automatically detects the camera as a new device on the first connection.

## Windows

After the computer detects the camera, a message indicating the completion of the setting appears. Confirm the message and click "OK". The camera is recognized as a removable disk.

## Macintosh

When iPhoto started, exit iPhoto and start OLYMPUS Master 2.

- While the camera is connected to the computer, shooting functions are disabled.
- Connecting the camera to a computer via a USB hub may cause unstable operation.
- When [MTP] is set for the submenu that appears by pressing after selecting [PC] in Step 3, images cannot be transferred to a computer using OLYMPUS Master 2.

## Starting OLYMPUS Master 2

### 1 Double-click the OLYMPUS Master 2 icon .

## Windows

appears on the desktop.

## Macintosh

appears in the OLYMPUS Master 2 folder.

- Browse window appears after starting the software.
- When you start OLYMPUS Master 2 for the first time after installation, "Default Settings" and "Registration" screens appear. Follow the instructions on the screen.



## Operating OLYMPUS Master 2

When OLYMPUS Master 2 is started, Quick Start Guide appears on the screen that helps you to handle the camera without any question. When the Quick Start Guide is not displayed, click  in the toolbar to show the Guide.



For details on the operation, refer to the help guide of the software.



## Transferring and saving images without using OLYMPUS Master 2

This camera is compatible with the USB Mass Storage Class. You can transfer and save the image data on your computer while the camera and the computer are connected.

### System requirements

Windows : Windows 2000 Professional/  
XP Home Edition/  
XP Professional/Vista

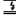
Macintosh : Mac OS X v10.3 or later

-  On a computer running Windows Vista, if [MTP] is set for the submenu that appears by pressing  after selecting [PC] in Step 3 of "Connecting the camera to a computer" (p. 40), Windows Photo Gallery will become available:
-  Even if a computer has USB ports, proper operation is not guaranteed in the following cases:
  - Computers with USB ports installed using an expansion card, etc.
  - Computers without a factory-installed OS and home-built computers



# Usage Tips

If the camera does not work as intended, or if an error message is displayed on the screen, and you are unsure of what to do, refer to the information below to fix the problem(s).

## Troubleshooting

### Battery

**“The camera does not work even when battery is installed”**

- Insert recharged battery in the correct direction.

“Charging the battery” (p. 10), “Loading the battery and the xD-Picture Card™ (sold separately) into the camera” (p. 11)

- Battery performance may have been reduced temporarily due to low temperature. Take the battery out of the camera, and warm it by putting it in your pocket for a while.

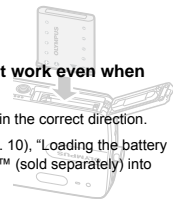

### Card/Internal memory

**“An error message is displayed”**

“Error message” (p. 43)





### Shutter button

**“No picture is taken when the shutter button is pressed”**

- Cancel sleep mode.

To save battery power, the camera automatically goes into sleep mode and the monitor turns off if there is no operation after 3 minutes when the camera is turned on. No picture is taken even if the shutter button is fully pressed in this mode. Operate the zoom button or other buttons to restore the camera from sleep mode before taking a picture. If the camera is left for 12 minutes, it automatically turns off.

Press the **ON/OFF** button to turn on the camera.

- Press the  button to set a shooting mode.
- Wait until  (flash charge) stops blinking before taking pictures.

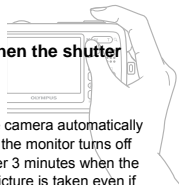

### Monitor

**“Difficult to see”**

- Condensation\*<sup>1</sup> may have formed. Turn off the power and wait for the camera body to become acclimated to the surrounding temperature and dry out before taking pictures.

\*<sup>1</sup> Dew drops can form in the camera when it is suddenly taken from a cold location into a warm, humid room.

**“Vertical lines appear on the screen”**

- Vertical lines may appear on the screen at times such as when the camera is pointed at an extremely bright subject under a clear sky. The lines do not appear, however, in the final still image.

**“The light is caught in the picture”**

- Shooting with flash in dark situations results in an image with many flash reflections on dust in the air.

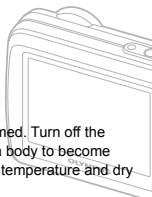

### Date and time function

**“Date and time settings return to the default setting”**

- If the battery is removed and left out of the camera for about 1 day\*<sup>2</sup>, the date and time settings return to the default setting and must be reset.

\*<sup>2</sup> The time until the date and time settings return to the default setting varies depending on how long the battery have been loaded.

“Setting the date and time” (p. 13)

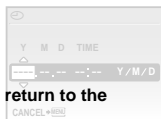















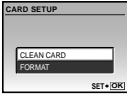

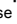





### Other

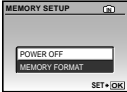



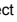

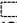
**“There is a noise coming from inside the camera during shooting”**

- The movement of the lens may make a noise even if the camera is not being operated because the autofocus function is active when the camera is ready to shoot.

## Error message

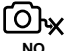
- When one of the messages below is displayed on the monitor, check the corrective action.

Error message	Corrective action
 <b>CARD ERROR</b>	<b>Card problem</b> Insert a new card.
 <b>WRITE PROTECT</b>	<b>Card problem</b> Use a computer to cancel the read-only setting.
 <b>MEMORY FULL</b>	<b>Internal memory problem</b> <ul style="list-style-type: none"> <li>Insert a card.</li> <li>Erase unwanted images.<sup>1</sup></li> </ul>
 <b>CARD FULL</b>	<b>Card problem</b> <ul style="list-style-type: none"> <li>Replace the card.</li> <li>Erase unwanted images.<sup>1</sup></li> </ul>
	<b>Card problem</b> <ul style="list-style-type: none"> <li>Use   to select [CLEAN CARD], and press the  button. Take out the card, wipe the contact area (p. 47) with a soft, dry cloth, and then load the card again.</li> <li>Use   to select [FORMAT], and press the  button. Next, use   to select [YES], and press the  button.<sup>2</sup></li> </ul>
	<b>Internal memory problem</b> Use   to select [MEMORY FORMAT], and press the  button. Next, use   to select [YES], and press the  button. <sup>2</sup>
 <b>NO PICTURE</b>	<b>Internal memory/Card problem</b> Take pictures before viewing them.
 <b>PICTURE ERROR</b>	<b>Problem with selected image</b> Use photo retouch software, etc. to view the image on a computer. If the image still cannot be viewed, the image file is corrupted.

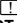
Error message	Corrective action
 <b>THE IMAGE CANNOT BE EDITED</b>	<b>Problem with selected image</b> Use photo retouch software, etc. to edit the image on a computer.
 <b>CARD-COVER OPEN</b>	<b>Operation problem</b> Close the battery/card compartment cover.
 <b>BATTERY EMPTY</b>	<b>Battery problem</b> Charge the battery.
 <b>NO CONNECTION</b>	<b>Connection problem</b> Connect the camera and computer or printer correctly.
 <b>NO PAPER</b>	<b>Printer problem</b> Load paper into the printer.
 <b>NO INK</b>	<b>Printer problem</b> Refill the ink in the printer.
 <b>JAMMED</b>	<b>Printer problem</b> Remove the jammed paper.
<b>SETTINGS CHANGED</b> <sup>3</sup>	<b>Printer problem</b> Return to the status where the printer can be used.
 <b>PRINT ERROR</b>	<b>Printer problem</b> Turn off the camera and printer, check the printer for any problems, and then turn the power on again.
 <b>CANNOT PRINT</b> <sup>4</sup>	<b>Problem with selected image</b> Use a computer to print.

<sup>1</sup> Before erasing important images, download them to a computer.

<sup>2</sup> All data will be erased.

<sup>3</sup> This is displayed, for instance, when the printer's paper tray has been removed. Do not operate the printer while making the print settings on the camera.

<sup>4</sup> This camera may be unable to print images taken by other cameras.

## Shooting tips

When you are unsure of how to take a picture that you envision, refer to the information below.

### Focusing

#### “Focusing on the subject”

- **Taking a picture of a subject not in the center of the screen**

After focusing on an object at the same distance as the subject, compose the shot, and take the picture.

Pressing the shutter button halfway (p. 14)

AF lock (p. 18)

- **Taking a picture of subjects where autofocus is difficult**

In the following cases, after focusing on an object (by pressing the shutter button halfway down) with high contrast at the same distance as the subject, compose the shot and take the picture.

Subjects with low contrast



When extremely bright objects appear in the center of the screen



Object with no vertical lines<sup>1</sup>

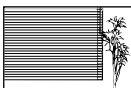

<sup>1</sup> It is also effective to compose the shot by holding the camera vertically to focus, and then returning to the horizontal position to take the picture.

When objects are at different distances



Fast-moving object

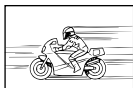

The subject is not in the center of the frame



### Camera shake



#### “Taking pictures without camera shake”

- **Taking pictures using [M] mode (p. 18)**
- **Taking picture with [SPORT] (p. 17)**

Since you can take pictures with a high shutter speed by setting [SPORT], it's also effective for blurry subjects.

- **Taking pictures at a high ISO sensitivity**

If a high ISO sensitivity is selected, pictures can be taken at a high shutter speed even at locations where a flash cannot be used.

[ISO] (p. 25)

## Exposure (brightness)



### “Taking pictures with the right brightness”

- **Taking pictures using [FACE DETECT] (p. 27)**

Appropriate exposure is obtained for a face against the backlight, and the face is brightened.

- **Taking pictures using [FILL IN] (p. 20) flash**

A subject against a backlight is brightened.

- **Taking pictures using exposure compensation (p. 21)**

Adjust the brightness while viewing the screen for taking the picture. Normally, taking pictures of white subjects (such as snow) results in images that are darker than the actual subject. Use the  button to adjust in the positive direction to express whites as they appear. When taking pictures of black subjects, on the other hand, it is effective to adjust in the negative direction.

## Color hue

# WB

### “Taking pictures with colors at the same shade as they appear”

- **Taking pictures by selecting [WB] (p. 25)**

Best results in most environments can normally be obtained with the AUTO setting, but for some subjects, you should try experimenting with different settings. (This is especially true for sunshade under a clear sky, mixed natural and artificial light settings, and so on.)

## Image quality



### “Taking sharper pictures”

- **Taking pictures with the optical zoom**

Avoid using [DIGITAL ZOOM] (p. 25) to take pictures.

- **Taking pictures at a low ISO sensitivity**

If the picture is taken with a high ISO sensitivity, noise (small colored spots and color unevenness that were not in the original image) can occur, and the image can appear grainy.

[ISO] (p. 25)

## Battery



### “Making battery last longer”

- **Avoid performing the following operations as much as possible as they use up battery power even if no pictures are actually taken**

- Repeatedly pressing the shutter button halfway.

- Repeatedly using the zoom.

- **Set [POWER SAVE] (p. 33) to [ON]**

## Playback/Editing tips

### Playback



#### “Playing images in the internal memory and card”

- **Remove the card when playing back pictures in the internal memory**

- “Loading the battery and the xD-Picture card™ (sold separately) into the camera” (p. 11)

- “Using a microSD card/microSDHC card (sold separately)” (p. 12)

### Editing



#### “Erasing the sound recorded to a still image”

- **Record over the sound with silence when playing back the image**

[ (Add sound to still picture)] (p. 29)

## Camera care

### Exterior

- Wipe gently with a soft cloth. If the camera is very dirty, soak the cloth in mild soapy water and wring well. Wipe the camera with the damp cloth and then dry it with a dry cloth. If you have used the camera at the beach, use a cloth soaked in clean water and wrung well.
- If any dirt, dust, sand, or other foreign material adheres to the periphery of the lens cover after use, or the lens cover does not move smoothly, wash the camera using the method described on P. 50.

### Monitor

- Wipe gently with a soft cloth.

### Lens

- Blow dust off the lens with a commercial blower, then wipe gently with a lens cleaner.

### Battery/Charger

- Wipe gently with a soft, dry cloth.
  - ❗ Do not use strong solvents such as benzene or alcohol, or chemically treated cloth.
  - ❗ Mold may form on the lens surface if the lens is left dirty.

## Storage

- When storing the camera for extended periods, remove the battery, AC adapter and card, and keep in a cool, dry place that is well ventilated.
- Periodically insert the battery and test the camera functions.
  - ❗ Avoid leaving the camera in places where chemical products are handled since this may result in corrosion.

## Battery and charger

- This camera uses one Olympus lithium ion battery (LI-42B/LI-40B). No other type of batteries can be used.

### CAUTION

There is a risk of explosion if the battery is replaced with the incorrect battery type. Dispose of the used battery following the instructions (p. 54).

- Power consumption by the camera varies depending on which functions are used.
- During the conditions described below, power is consumed continuously and the battery becomes exhausted quickly.
  - The zoom is used repeatedly.
  - The shutter button is pressed halfway repeatedly in shooting mode, activating the auto focus.
  - A picture is displayed on the monitor for an extended period of time.
  - The camera is connected to a computer or printer.
- Using an exhausted battery may cause the camera to turn off without displaying the battery level warning.
- The rechargeable battery is not fully charged at the time of purchase. Charge the battery fully with the LI-41C/LI-40C charger before use.
- The provided rechargeable battery usually takes approximately 2 hours to charge (varies with usage).
- The supplied LI-41C battery charger is used only for LI-42B/LI-40B battery. Do not charge other type of battery with the supplied battery charger. It might cause explosion, leaking, overheating or fire.
- For plug-in type battery charger: This power unit is intended to be correctly orientated in a vertical or floor mount position.

## Using an AC adapter

An AC adapter is useful for time-consuming tasks such as image downloads to a computer or when running a slideshow for a long period of time. To use an AC adapter for this camera, the multi-adapter (CB-MA1/accessory) is required. Do not use any other AC adapter with this camera.

## Using your charger and AC adapter abroad

- The charger and AC adapter can be used in most home electrical sources within the range of 100 V to 240 V AC (50/60Hz) around the world. However, depending on the country or area you are in, the AC wall outlet may be shaped differently and the charger and AC adapter may require a plug adapter to match the wall outlet. For details, ask at your local electrical shop or travel agent.
- Do not use travel voltage converters as they could damage your charger and AC adapter.

## Using an xD-Picture Card

A card (and internal memory) also corresponds to the film that records images in a film camera. Otherwise, the recorded images (data) can be erased, and retouching is also available with the use of a computer. Cards can be removed from the camera and exchanged, but this is not possible with the internal memory. Use of larger capacity cards enables you to take more pictures.

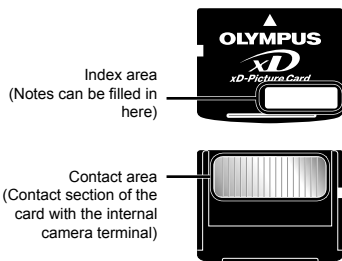

⚠ Do not touch the contact area directly.

## Cards compatible with this camera

xD-Picture Card (16MB to 2GB)  
(TypeH/M/M+, Standard)

## Using a new card

Before using a non-Olympus card or a card that was used for another purpose in a computer or other device, use [MEMORY FORMAT]/[FORMAT] (p. 31) to format the card.

## Checking the image saving location

The memory indicator shows whether the internal memory or card is being used during shooting and playback.

## Current memory indicator

- ☑: Internal memory is being used
- None: Card is being used

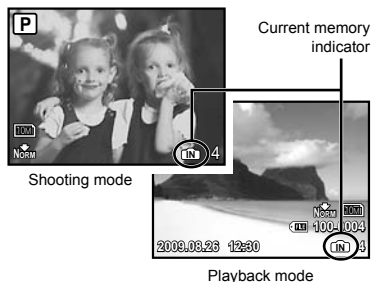

- ⚠ Even if [MEMORY FORMAT]/[FORMAT], [ERASE], [SEL. IMAGE], or [ALL ERASE] is performed, the data in the card is not completely erased. When disposing of the card, damage the card to prevent the disclosure of personal data.

## Readout/recording process of the card

Never open the battery/card compartment cover or unplug the USB cable while the camera is reading or writing data, which is indicated by blinking of the card access lamp. This can not only damage the image data but also render the internal memory or card unusable.

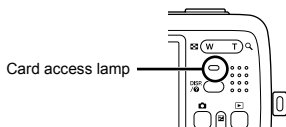

## Number of storable pictures (still pictures)/continuous recording length (movies) in the internal memory and xD-Picture Card

### Still pictures

IMAGE SIZE	COMPRES- SION	Number of storable still pictures			
		Internal memory		Using a 1GB card (xD-Picture Card)	
		With sound	Without sound	With sound	Without sound
10M	FINE	2	2	178	179
	NORM	5	5	347	353
5M	FINE	5	5	353	359
	NORM	9	10	673	695
3M	FINE	8	8	566	576
	NORM	16	16	1102	1142
2M	FINE	13	13	913	940
	NORM	25	27	1728	1881
1M	FINE	20	21	1390	1453
	NORM	37	42	2558	2907
VGA	FINE	67	85	4568	5814
	NORM	118	157	7995	10660
16:9	FINE	12	12	841	876
	NORM	23	25	1640	1728

### Movies

IMAGE SIZE	FRAME RATE	Continuous recording length			
		Internal memory		Using a 1 GB card (xD-Picture Card)	
		With sound	Without sound	With sound	Without sound
VGA	30	7 sec.	7 sec.	9 min. 00 sec.*	9 min. 05 sec.*
	15	15 sec.	15 sec.	17 min. 48 sec.	18 min. 11 sec.
QVGA	30	21 sec.	22 sec.	24 min. 43 sec.	25 min. 28 sec.
	15	41 sec.	44 sec.	48 min. 04 sec.	50 min. 56 sec.

⚠ The maximum file size of a single movie is 2 GB, regardless of the capacity of the card.

\* The maximum length is 10 seconds when using a TypeM or Standard xD-Picture Card.



## Increasing the number of pictures that can be taken

Either erase unwanted images, or connect the camera to a computer or other device to save the images, and then erase the images in the internal memory or card.

[ERASE] (p. 16), [SEL. IMAGE] (p. 30), [ALL ERASE] (p. 30), [MEMORY FORMAT]/[FORMAT] (p. 31)

## Using a microSD Attachment

❗ Do not use the attachment with Olympus digital cameras that do not support this microSD Attachment, as well as with other brands of digital cameras, computers, printers, and other devices that support xD-Picture Card. Doing so not only may damage the pictures taken, but may also result in the malfunction of the device.

❗ If the microSD card cannot be removed, do not use force. Contact authorized distributors/service centers.

## Cards compatible with this camera

microSD card/microSDHC card

❗ For a list of tested microSD cards, please visit our website (<http://www.olympus.com/>).

## Sending images

You can send images to a computer or PictBridge-compatible printer by using the USB cable provided with the camera.

To send data to other devices, remove the attachment from the camera and use a commercially available microSD card adapter.

## Handling precautions

Do not touch the contact area of the attachment or microSD card. Doing so may cause failure in reading the images. When fingerprints or stains are found on the contact area, wipe the area with a soft dry cloth.

## Important information about water resistant feature

The waterproof feature is warranted<sup>\*1</sup> to operate at depths up to 3 m (9.8 feet) for up to one hour. The waterproof feature may be compromised if the camera is subject to substantial or excessive impact.

As with any electronic device, proper care and maintenance are required to preserve the integrity and operation of your camera. To maintain camera performance, please take your camera to the nearest Olympus Authorized Service Center to have it inspected after any major impact. In the event the camera is damaged as a result of negligence or misuse, the warranty will not cover costs associated with the service or repair of your camera. For additional information on our warranty, please visit to the Olympus website for your local area. Please observe the following care instructions for your camera.

\*1 As determined by Olympus pressure testing equipment in accordance with IEC Standard Publication 529 IPX8 - This means that the camera can be used normally under water at a specified water pressure.

## Before Use:

- Check the camera for foreign material including dirt, dust or sand.
- Be sure to close the battery/card compartment cover and connector cover firmly so that each lock makes clicking sound.
- Do not open the battery/card compartment cover and connector cover with wet hands, while under water, or in a damp or dusty environment (e.g. beach).

### After Use:

- Be sure to wipe off any excess water or debris after using the camera under water.
- **After the camera is used under seawater, immerse the camera in a bucket containing fresh water for about 10 minutes (with the battery/card compartment cover and connector cover firmly closed).** After that, dry the camera in a shade with good ventilation.
- **Water drops may be observed on the inner surface of the battery/card compartment cover or connector cover after you open each cover. If any water drops are found, be sure to wipe them off before using the camera.**

### Notes after use

- Any foreign material may be adhered to the periphery of the lens cover, after you use the camera in an environment containing foreign material including dirt, dust or sand, or when the lens cover won't move smoothly. If you continue to use the camera in such a condition, the lens may be damaged or the lens cover may become stuck, causing a failure. To avoid such a failure, wash the camera using the following method.
  - ① Insert the battery and close the battery/ card compartment cover and connector cover firmly so that each lock makes the clicking sound.
  - ② Fill a bucket with fresh water, immerse the camera in the bucket with the lens surface downward and shake the camera thoroughly.
  - ③ Press the **ON/OFF** button several times in the water and close/open the lens cover repeatedly.
  - ④ Furthermore, shake the camera further with the cover opened.



Follow Steps ① to ④, then check if the lens cover moves smoothly. If the lens cover does not move smoothly, rinse the lens face by placing it directly under a strong stream of tap water and pressing the **ON/OFF** button repeatedly.

### Storage and Maintenance



- Do not leave the camera in an environment at high temperature (40°C (104°F) or more) or at low temperature (0°C (32°F) or less). Failure to do so may break down water resistance.
- Do not use chemicals for cleaning, rust prevention, anti-fogging, repairing, etc. Failure to do so may break down water resistance.
- **Do not leave the camera in water for a long time. Failure to do so will cause damage to the camera's appearance and/or deteriorate water resistance.**
- **In order to preserve the water resistant feature, as with any underwater housing, it is recommended that the waterproof packing (and seals) are replaced annually. For the Olympus distributors or service stations where the waterproof packing can be replaced, visit Olympus website for your local area.**

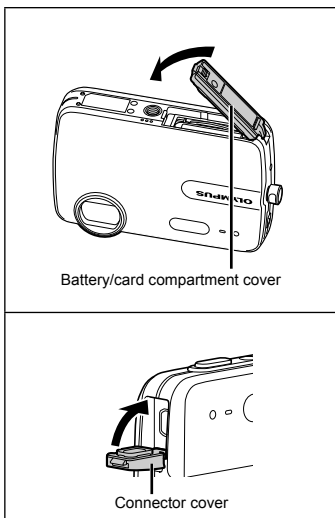



## Closing Battery/card compartment cover and Connector cover



- ⚠ The included accessories (e.g. charger) do not offer shock or water resistance.

## SAFETY PRECAUTIONS

	<b>CAUTION</b> RISK OF ELECTRIC SHOCK DO NOT OPEN	
CAUTION: TO REDUCE THE RISK OF ELECTRICAL SHOCK, DO NOT REMOVE COVER (OR BACK). NO USER-SERVICEABLE PARTS INSIDE. REFER SERVICING TO QUALIFIED OLYMPUS SERVICE PERSONNEL.		

-  An exclamation mark enclosed in a triangle alerts you to important operating and maintenance instructions in the documentation provided with the product.
-  **DANGER** If the product is used without observing the information given under this symbol, serious injury or death may result.
-  **WARNING** If the product is used without observing the information given under this symbol, injury or death may result.
-  **CAUTION** If the product is used without observing the information given under this symbol, minor personal injury, damage to the equipment, or loss of valuable data may result.

**WARNING!**  
TO AVOID THE RISK OF FIRE OR ELECTRICAL SHOCK, NEVER DISASSEMBLE, EXPOSE THIS PRODUCT TO WATER OR OPERATE IN A HIGH HUMIDITY ENVIRONMENT.

### General Precautions

- Read All Instructions** — Before you use the product, read all operating instructions. Save all manuals and documentation for future reference.
- Cleaning** — Always unplug this product from the wall outlet before cleaning. Use only a damp cloth for cleaning. Never use any type of liquid or aerosol cleaner, or any type of organic solvent to clean this product.
- Attachments** — For your safety, and to avoid damaging the product, use only accessories recommended by Olympus.
- Water and Moisture** — For precautions on products with weatherproof designs, read the weatherproofing sections.
- Location** — To avoid damage to the product, mount the product securely on a stable tripod, stand, or bracket.
- Power Source** — Connect this product only to the power source described on the product label.
- Lightning** — If a lightning storm occurs while using an AC adapter, remove it from the wall outlet immediately.
- Foreign Objects** — To avoid personal injury, never insert a metal object into the product.
- Heat** — Never use or store this product near any heat source such as a radiator, heat register, stove, or any type of equipment or appliance that generates heat, including stereo amplifiers.

## Handling the Camera

### WARNING

- **Do not use the camera near flammable or explosive gases.**
- **Do not use the flash and LED on people (infants, small children, etc.) at close range.**
  - You must be at least 1 m (3 ft.) away from the faces of your subjects. Firing the flash too close to the subject's eyes could cause a momentary loss of vision.
- **Keep young children and infants away from the camera.**
  - Always use and store the camera out of the reach of young children and infants to prevent the following dangerous situations which could cause serious injury:
    - Becoming entangled in the camera strap, causing strangulation.
    - Accidentally swallowing the battery, cards or other small parts.
    - Accidentally firing the flash into their own eyes or those of another child.
    - Accidentally being injured by the moving parts of the camera.
- **Do not look at the sun or strong lights with the camera.**
- **Do not use or store the camera in dusty or humid places.**
- **Do not cover the flash with a hand while firing.**
- **Do not insert anything into the microSD Attachment other than the microSD card.**

This attachment is exclusive for use of microSD cards only. Other types of cards cannot be installed.
- **Do not insert anything other than an xD-Picture Card or the microSD Attachment into the camera.**

If you insert a card by mistake, such as a microSD card, do not use force. Contact authorized distributors/service centers.

### CAUTION

- **Stop using the camera immediately if you notice any unusual odors, noise, or smoke around it.**
  - Never remove the batteries with bare hands, which may cause a fire or burn your hands.
- **Do not leave the camera in places where it may be subject to extremely high temperatures.**
  - Doing so may cause parts to deteriorate and, in some circumstances, cause the camera to catch fire. Do not use the charger or AC adapter if it is covered (such as a blanket). This could cause overheating, resulting in fire.
- **Handle the camera with care to avoid getting a low-temperature burn.**
  - When the camera contains metal parts, overheating can result in a low-temperature burn. Pay attention to the following:
    - When used for a long period, the camera will get hot. If you hold on to the camera in this state, a low-temperature burn may be caused.
    - In places subject to extremely cold temperatures, the temperature of the camera's body may be lower than the environmental temperature. If possible, wear gloves when handling the camera in cold temperatures.
- **Be careful with the strap.**
  - Be careful with the strap when you carry the camera. It could easily catch on stray objects and cause serious damage.

## Battery Handling Precautions

**Follow these important guidelines to prevent batteries from leaking, overheating, burning, exploding, or causing electrical shocks or burns.**

### DANGER

- The camera uses a lithium ion battery specified by Olympus. Charge the battery with the specified charger. Do not use any other chargers.
- Never heat or incinerate batteries.
- Take precautions when carrying or storing batteries to prevent them from coming into contact with any metal objects such as jewelry, pins, fasteners, etc.
- Never store batteries where they will be exposed to direct sunlight, or subjected to high temperatures in a hot vehicle, near a heat source, etc.
- To prevent causing battery leaks or damaging their terminals, carefully follow all instructions regarding the use of batteries. Never attempt to disassemble a battery or modify it in any way, solder, etc.
- If battery fluid gets into your eyes, flush your eyes immediately with clear, cold running water and seek medical attention immediately.
- Always store batteries out of the reach of small children. If a child accidentally swallows a battery, seek medical attention immediately.

### WARNING

- Keep batteries dry at all times.
- To prevent batteries from leaking, overheating, or causing a fire or explosion, use only batteries recommended for use with this product.
- Insert the battery carefully as described in the operating instructions.
- If rechargeable batteries have not been recharged within the specified time, stop charging them and do not use them.
- Do not use a battery if it is cracked or broken.
- If a battery leaks, becomes discolored or deformed, or becomes abnormal in any other way during operation, stop using the camera.
- If a battery leaks fluid onto your clothing or skin, remove the clothing and flush the affected area with clean, running cold water immediately. If the fluid burns your skin, seek medical attention immediately.
- Never subject batteries to strong shocks or continuous vibration.

### CAUTION

- Before loading, always inspect the battery carefully for leaks, discoloration, warping, or any other abnormality.
- The battery may become hot during prolonged use. To avoid minor burns, do not remove it immediately after using the camera.
- Always unload the battery from the camera before storing the camera for a long period.

## Caution for Usage Environment

- To protect the high-precision technology contained in this product, never leave the camera in the places listed below, no matter if in use or storage:
  - Places where temperatures and/or humidity are high or go through extreme changes. Direct sunlight, beaches, locked cars, or near other heat sources (stove, radiator, etc.) or humidifiers.
  - In sandy or dusty environments.
  - Near flammable items or explosives.
  - In wet places, such as bathrooms or in the rain. When using products with weatherproof designs, read their manuals as well.
  - In places prone to strong vibrations.
- Never drop the camera or subject it to severe shocks or vibrations.
- When mounted on a tripod, adjust the position of the camera with the tripod head. Do not twist the camera.
- Do not touch electric contacts on cameras.
- Do not leave the camera pointed directly at the sun. This may cause lens or shutter curtain damage, color failure, ghosting on the CCD, or may possibly cause fires.
- Do not push or pull severely on the lens.
- Before storing the camera for a long period, remove the batteries. Select a cool, dry location for storage to prevent condensation or mold from forming inside the camera. After storage, test the camera by turning it on and pressing the shutter button to make sure that it is operating normally.
- Always observe the operating environment restrictions described in the camera's manual.

## Battery Handling Precautions

- This camera uses a lithium ion battery specified by Olympus. Do not use any other type of battery.
- If the battery's terminals get wet or greasy, camera contact failure may result. Wipe the battery well with a dry cloth before use.
- Always charge a battery when using it for the first time, or if it has not been used for a long period.
- When operating the camera with battery power at low temperatures, try to keep the camera and spare battery as warm as possible. A battery that has run down at low temperatures may be restored after it is warmed at room temperature.
- The number of pictures you can take may vary depending on the shooting conditions or battery.
- Before going on a long trip, and especially before traveling abroad, purchase extra batteries. A recommended battery may be difficult to obtain while traveling.
- Please recycle batteries to help save our planet's resources. When you throw away dead batteries, be sure to cover their terminals and always observe local laws and regulations.

## LCD Monitor

- Do not push the monitor forcibly; otherwise the image may become vague, resulting in a playback mode failure or damage to the monitor.
- A strip of light may appear on the top/bottom of the monitor, but this is not a malfunction.
- When a subject is viewed diagonally in the camera, the edges may appear zigzagged on the monitor. This is not a malfunction; it will be less noticeable in playback mode.
- In places subject to low temperatures, the LCD monitor may take a long time to turn on or its color may change temporarily. When using the camera in extremely cold places, it is a good idea to occasionally place it in a warm place. An LCD monitor exhibiting poor performance due to low temperatures will recover in normal temperatures.
- The LCD used for the monitor is made with high-precision technology. However, black spots or bright spots of light may appear constantly on the LCD monitor. Due to its characteristics or the angle at which you are viewing the monitor, the spot may not be uniform in color and brightness. This is not a malfunction.

## Legal and Other Notices

- Olympus makes no representations or warranties regarding any damages, or benefit expected by using this unit lawfully, or any request from a third person, which are caused by the inappropriate use of this product.
- Olympus makes no representations or warranties regarding any damages or any benefit expected by using this unit lawfully which are caused by erasing picture data.

## Disclaimer of Warranty

- Olympus makes no representations or warranties, either expressed or implied, by or concerning any content of these written materials or software, and in no event shall be liable for any implied warranty of merchantability or fitness for any particular purpose or for any consequential, incidental or indirect damages (including but not limited to damages for loss of business profits, business interruption and loss of business information) arising from the use or inability to use these written materials or software or equipment. Some countries do not allow the exclusion or limitation of liability for consequential or incidental damages, so the above limitations may not apply to you.
- Olympus reserves all rights to this manual.

## Warning

Unauthorized photographing or use of copyrighted material may violate applicable copyright laws. Olympus assumes no responsibility for unauthorized photographing, use or other acts that infringe upon the rights of copyright owners.

## Copyright Notice

All rights reserved. No part of these written materials or this software may be reproduced or used in any form or by any means, electronic or mechanical, including photocopying and recording or the use of any type of information storage and retrieval system, without the prior written permission of Olympus. No liability is assumed with respect to the use of the information contained in these written materials or software, or for damages resulting from the use of the information contained therein. Olympus reserves the right to alter the features and contents of this publication or software without obligation or advance notice.

## For customers in Europe



"CE" mark indicates that this product complies with the European requirements for safety, health, environment and customer protection. "CE" mark cameras are intended for sales in Europe.



This symbol [crossed-out wheeled bin WEEE Annex IV] indicates separate collection of waste electrical and electronic equipment in the EU countries. Please do not throw the equipment into the domestic refuse.



Please use the return and collection systems available in your country for the disposal of this product.



This symbol [crossed-out wheeled bin Directive 2006/66/EC Annex II] indicates separate collection of waste batteries in the EU countries. Please do not throw the batteries into the domestic refuse. Please use the return and collection systems available in your country for the disposal of the waste batteries.

## Use Only Dedicated Rechargeable Battery and Battery Charger

We strongly recommend that you use only the genuine Olympus dedicated rechargeable battery and battery charger with this camera. Using a non-genuine rechargeable battery and/or battery charger may result in fire or personal injury due to leakage, heating, ignition or damage to the battery. Olympus does not assume any liability for accidents or damage that may result from the use of a battery and/or battery charger that are not genuine Olympus accessories.

## Provisions of warranty

- If this product proves to be defective, although it has been used properly (in accordance with the written Safety Precautions and Operating instructions supplied with it), during a period of two years from the date of purchase from an authorized Olympus distributor within the business area of Olympus Imaging Europa GmbH as stipulated on the website: <http://www.olympus.com> this product will be repaired, or at Olympus's option replaced, free of charge. To claim under this warranty the customer must take the product and this Warranty Certificate before the end of the two year warranty period to the dealer where the product was purchased or any other Olympus service station within the business area of Olympus Imaging Europa GmbH as stipulated on the website: <http://www.olympus.com>. During the one year period of the World Wide Warranty the customer may turn the product in at any Olympus service station. Please notice that not in all countries such Olympus service station exists.

- 2 The customer shall transport the product to the dealer or Olympus authorized service station at his own risk and shall be responsible for any costs incurred in transporting the product.
- 3 This warranty does not cover the following and the customer will be required to pay repair charge, even for defects occurring within the warranty period referred to above.
  - a. Any defect that occurs due to mishandling (such as an operation performed that is not mentioned in the Safety Precautions or other sections of the instructions, etc.)
  - b. Any defect that occurs due to repair, modification, cleaning, etc. performed by anyone other than Olympus or an Olympus authorized service station.
  - c. Any defect or damage that occurs due to transport, a fall, shock, etc. after purchase of the product.
  - d. Any defect or damage that occurs due to fire, earthquake, flood damage, thunderbolt, other natural disasters, environmental pollution and irregular voltage sources.
  - e. Any defect that occurs due to careless or improper storage (such as keeping the product under conditions of high temperature and humidity, near insect repellents such as naphthalene or harmful drugs, etc.), improper maintenance, etc.
  - f. Any defect that occurs due to exhausted batteries, etc.
  - g. Any defect that occurs due to sand, mud, etc. entering the inside of the product casing.
  - h. When this Warranty Certificate is not returned with the product.
  - i. When any alterations whatsoever are made to the Warranty Certificate regarding the year, month and date of purchase, the customer's name, the dealer's name, and the serial number.
  - j. When proof of purchase is not presented with this Warranty Certificate.
- 4 This Warranty applies to the product only; the Warranty does not apply to any other accessory equipment, such as the case, strap, lens cap and batteries.
- 5 Olympus's sole liability under this warranty shall be limited to repairing or replacing the product. Any liability for indirect or consequential loss or damage of any kind incurred or suffered by the customer due to a defect of the product, and in particular any loss or damage caused to any lenses, films, other equipment or accessories used with the product or for any loss resulting from a delay in repair or loss of data, is excluded. Compelling regulations by law remain unaffected by this.

## Notes regarding warranty maintenance

- 1 This warranty will only be valid if the Warranty Certificate is duly completed by Olympus or an authorized dealer or other documents contain sufficient proof. Therefore, please make sure that your name, the name of the dealer, the serial number and the year, month and date of purchase are all completed or the original invoice or the sales receipt (indicating the dealer's name, the date of purchase and product type) is attached to this Warranty Certificate. Olympus reserves the right to refuse free-of-charge service if neither Warranty Certificate is completed nor the above document is attached or if the information contained in it is incomplete or illegible.
  - 2 Since this Warranty Certificate will not be re-issued, keep it in a safe place.
- \* Please refer to the list on the website: <http://www.olympus.com> for the authorized international Olympus service network.

## Trademarks

- IBM is a registered trademark of International Business Machines Corporation.
- Microsoft and Windows are registered trademarks of Microsoft Corporation.
- Macintosh is a trademark of Apple Inc.
- xD-Picture Card™ is a trademark.
- microSD is a trademark of the SD Association.
- All other company and product names are registered trademarks and/or trademarks of their respective owners.
- The standards for camera file systems referred to in this manual are the "Design rule for Camera File system/DCF" standards stipulated by the Japan Electronics and Information Technology Industries Association (JEITA).



## SPECIFICATIONS

### Camera

<b>Product type</b>	: Digital camera (for shooting and displaying)
<b>Recording system</b>	
<b>Still pictures</b>	: Digital recording, JPEG (in accordance with Design rule for Camera File system (DCF))
<b>Applicable standards</b>	: Exif 2.2, Digital Print Order Format (DPOF), PRINT Image Matching III, PictBridge
<b>Sound with still pictures</b>	: Wave format
<b>Movie</b>	: AVI Motion JPEG
<b>Memory</b>	: Internal memory xD-Picture Card (16 MB to 2 GB) (TypeH/MM+, Standard) microSD card/microSDHC card (with the supplied microSD Attachment)
<b>No. of effective pixels</b>	: 9,980,000 pixels
<b>Image pickup device</b>	: 1/2.33" CCD (primary color filter), 10,700,000 pixels (gross)
<b>Lens</b>	: Olympus lens 6.7 to 20.1 mm, f3.5 to 5.0 (equivalent to 38 to 114 mm on a 35mm camera)
<b>Photometric system</b>	: Digital ESP metering system
<b>Shutter speed</b>	: 4 to 1/1000 sec.
<b>Shooting range</b>	: 0.5 m (1.6 ft.) to ∞ (W/T) (normal) 0.2 m (0.7 ft.) to ∞ (W), 0.3 m (1.0 ft.) to ∞ (T) (macro mode) 0.07 m (2.8 in.) to ∞ (W only) (super macro mode)
<b>Monitor</b>	: 2.5" TFT color LCD display, 230,000 dots
<b>Connector</b>	: Multi-connector (DC-IN jack USB connector, A/V OUT jack)
<b>Automatic calendar system</b>	: 2000 up to 2099
<b>Water resistance</b>	
<b>Type</b>	: Equivalent to IEC Standard publication 529 IPX8 (under OLYMPUS test conditions), available in 3 m (9.8 feet) deep water
<b>Meaning</b>	: Camera can normally be used under water at a specified water pressure.
<b>Operating environment</b>	
<b>Temperature</b>	: 0 °C to 40 °C (32 °F to 104 °F) (operation)/ -20 °C to 60 °C (-4 °F to 140 °F) (storage)
<b>Humidity</b>	: 30 % to 90 % (operation)/10 % to 90 % (storage)
<b>Power supply</b>	: One Olympus lithium ion battery (LI-42B/LI-40B) or Olympus AC adapter
<b>Dimensions</b>	: 93.6 mm (W) × 61.7 mm (H) × 21.5 mm (D) (3.7 × 2.4 × 0.8 in.) (excluding protrusions)
<b>Weight</b>	: 127 g (4.5 oz) (excluding battery and card)

## Lithium ion battery (LI-42B)

<b>Product type</b>	: Lithium ion rechargeable battery
<b>Standard voltage</b>	: DC 3.7 V
<b>Standard capacity</b>	: 740 mAh
<b>Battery life</b>	: Approx. 300 full charges (varies on usage)
<b>Operating environment</b>	
<b>Temperature</b>	: 0°C to 40°C (32°F to 104°F) (charging)/ -10°C to 60°C (14°F to 140°F) (operation)/ -20°C to 35°C (-4°F to 95°F) (storage)
<b>Dimensions</b>	: 31.5 mm (W) × 39.5 mm (H) × 6.0 mm (D) (1.2 × 1.5 × 0.2 in.)
<b>Weight</b>	: Approx. 15 g (0.5 oz)

## Battery charger (LI-41C)

<b>Model No.</b>	: LI-41CAA/LI-41CAB/LI-41CBA/LI-41CBB
<b>Power requirements</b>	: AC 100 to 240 V (50 to 60 Hz)
<b>Output</b>	: DC 4.2 V, 600 mA
<b>Charging time</b>	: Approx. 2 hours (when charging the supplied LI-42B)
<b>Operating environment</b>	
<b>Temperature</b>	: 0°C to 40°C (32°F to 104°F) (operation)/ -20°C to 60°C (-4°F to 140°F) (storage)
<b>Dimensions</b>	: 62.0 mm (W) × 23.5 mm (H) × 90.0 mm (D) (2.4 × 0.9 × 3.5 in.)
<b>Weight</b>	: Approx. 65 g (2.3 oz)

## microSD attachment

<b>Product type</b>	: Attachment for microSD
<b>Operating Environment</b>	
<b>Temperature</b>	: -10°C to 40°C (14°F to 104°F) (operation) / -20°C to 65°C (-4°F to 149°F) (storage)
<b>Humidity</b>	: 95% and below (operation) / 85% and below (storage)
<b>Dimensions</b>	: 25.0 mm (W) × 20.3 mm (H) × 1.7 mm (D) (1.0 × 0.8 × 0.07 in.) (Handle:2.2 mm (0.09 in.))
<b>Weight</b>	: Approx. 0.9 g (0.03 oz)

Design and specifications subject to change without notice.



## A

AC adapter.....	47
AF lock.....	18
ALL (PERFECT FIX).....	28
ALL INDEX.....	35
ALL PRINT.....	35
All-image print reservation  .....	38
AUTO (ISO).....	25
AUTO (WB).....	25
AV cable.....	2, 33



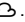
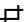

## B

Backlight boost.....	22
BACKUP.....	31
Battery.....	11, 42, 45, 46
Battery charger.....	2, 46
BEEP.....	32



## C

CAMERA MENU  .....	25
Card.....	11, 12, 47
Close-up view  .....	23
Cloudy day  .....	25
COLOR 1/2/3.....	32
COMPRESSION.....	24
Connection	
To Computer.....	40
To Printer.....	34
To Television.....	33
Cropping a picture  .....	28, 36
CUSTOM PRINT.....	35





## D

DATE  .....	38
DATE (PRINT INFO).....	36
Date and time  .....	13, 32
Digital image stabilization mode (DIS MODE)  .....	18
DIGITAL ZOOM.....	25
Direct printing.....	34
Display language  .....	13, 31
DPOF.....	37

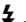

## E

EASY PRINT.....	34
EDIT  .....	28
Erase	
ALL ERASE.....	30
ERASE  .....	30
SEL.IMAGE.....	30
Single image erase.....	16
Exposure.....	14, 45
Exposure compensation  .....	21

## F

FACE DETECT.....	27
FILE NAME (PRINT INFO).....	36
FILL IN  .....	20
FINE.....	24
FLASH AUTO.....	20
Flash charge.....	42
Flash mode  .....	20
FLASH OFF  .....	20
Fluorescent lamp 1/2/3  .....	25
FORMAT.....	31
Format.....	31
FRAME RATE.....	24
FUNC menu.....	22

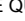

## I

IMAGE QUALITY  .....	24
IMAGE SIZE.....	24
Index view  .....	23
Information displays.....	22, 23
Internal memory.....	11, 47
ISO.....	25



## L

LIGHTING FIX.....	28
Lithium ion battery.....	2

## M

MACRO 	21
Macro mode 	21
MEMORY FORMAT	31
Menu	3
MENU COLOR	32
Menu guide	3
microSD Attachment	12, 49
microSD card	12, 49
microSDHC card	12, 49
Monitor brightness adjustment 	32
MULTI PRINT	35









## N

NO 	38
NORMAL	24
NORMAL (MENU COLOR)	32
NTSC	33
Number of prints  x	36

## O

OLYMPUS Master	2, 40
Optical zoom	20













## P

PAL	33
PANORAMA	26
PC	40
PERFECT FIX 	28
PictBridge	34
Picture rotation 	29
PIXEL MAPPING	31
PLAYBACK MENU 	29
Playback mode 	15
Playback on a TV	33
Power on  / 	31
POWER SAVE	33
PRINT ORDER 	30, 37
PRINT ORDER (PRINT SELECT MODE)	37
Print reservations	37
Printing pictures	34
Protect 	29

## R

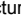
REDEYE 	20
REDEYE FIX	28
RESET 	27
Resizing 	28

## S

SAVE SETTINGS	32
<b>SCN</b> (Scene)	17
SELFTIMER 	21
SETUP 	31
Shooting mode	14
Shooting movies (MOVIE) 	18
Shooting still pictures (Full auto mode) <b>iAUTO</b>	17
Shooting still pictures <b>P</b>	14
SILENT MODE 	33
Single-frame print reservation 	37
SLIDESHOW 	28
Sound recording Adding sound to still pictures 	29
Recording sound with movie 	26
Recording sound with still pictures 	26
Strap	2, 10
Sunny day 	25
SUPER MACRO 	21
SWITCH SHOOTING MODES 	27

## T

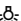
TIME 	38
Top menu	5
Tungsten light 	25
Turn the camera on	13, 14

## U

USB cable	2, 34, 40
-----------	-----------

## V

VIDEO OUT	33
-----------	----

---

**W**

White balance WB .....25

---

**X**

xD-Picture Card ..... 11, 47

---

**Z**

Zoom.....20



<http://www.olympus.com/>

### OLYMPUS IMAGING CORP.

Shinjuku Monolith, 3-1 Nishi-Shinjuku 2-chome, Shinjuku-ku, Tokyo, Japan

### OLYMPUS IMAGING AMERICA INC.

3500 Corporate Parkway, P.O. Box 610, Center Valley, PA 18034-0610, U.S.A. Tel. 484-896-5000

#### Technical Support (USA)

24/7 online automated help: <http://www.olympusamerica.com/support>

Phone customer support: Tel. 1-888-553-4448 (Toll-free)

Our phone customer support is available from 8am to 10pm

(Monday to Friday) and 9am to 5pm (Sunday) ET

<http://olympusamerica.com/contactus>

Olympus software updates can be obtained at: <http://www.olympusamerica.com/digital>

### OLYMPUS IMAGING EUROPA GMBH

Premises: Wendenstrasse 14-18, 20097 Hamburg, Germany

Tel: +49 40-23 77 3-0 / Fax: +49 40-23 07 61

Goods delivery: Bredowstrasse 20, 22113 Hamburg, Germany

Letters: Postfach 10 49 08, 20034 Hamburg, Germany

#### European Technical Customer Support:

Please visit our homepage <http://www.olympus-europa.com>

or call our TOLL FREE NUMBER\* : **00800 - 67 10 83 00**

for Austria, Belgium, Denmark, Finland, France, Germany, Italy, Luxemburg, Netherlands, Norway, Portugal, Spain, Sweden, Switzerland, United Kingdom

\* Please note some (mobile) phone services providers do not permit access or request an additional prefix to +800 numbers.

For all European Countries not listed and in case that you can't get connected to the above mentioned number, please make use of the following

CHARGED NUMBERS: **+49 180 5 - 67 10 83** or **+49 40 - 237 73 4899**

Our Technical Customer Support is available from 9 am to 6 pm MET (Monday to Friday)