

Digital Still Camera

Read This First

Operating Instructions

Before operating the unit, please read this manual and "User's Guide/Troubleshooting" (separate volume) thoroughly, and retain it for future reference.

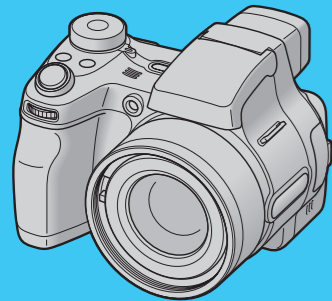

DSC-H1

Cyber-shot

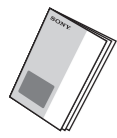

Refer to "User's Guide/Troubleshooting" (separate volume)

Explains advanced techniques and what to do if you experience trouble with your camera.

Printed on 100% recycled paper using VOC (Volatile Organic Compound)-free vegetable oil based ink.



© 2005 Sony Corporation Printed in Japan

1 Prepare the battery

**1 Insert the batteries.**  
Match ⊕/⊖ and insert.

**3 To wall outlet (wall socket)**

Battery charger

Power cord (mains lead)

**CHARGE lamp**  
Light on: Charging  
Light off: Completed (Remove the batteries.)

**2 Connect the power cord (mains lead).**

- Connect the battery charger to an easily accessible wall outlet (wall socket) close by.
- Even if the CHARGE lamp is not lit, the battery charger is not disconnected from the AC power source (mains) as long as it is connected to the wall outlet (wall socket). If some trouble occurs while using the battery charger, immediately shut off the power by disconnecting the plug from the wall outlet (wall socket).
- When charging is finished, disconnect the power cord (mains lead) from the wall outlet (wall socket), and remove the Nickel-Metal Hydride batteries from the battery charger.

Nickel-Metal Hydride battery	Charging time
NH-AA-DAx2 (supplied)	Approx. 6 hours

- Time required to charge fully depleted Nickel-Metal Hydride batteries at a temperature of 25°C (77°F). Charging may take longer under certain circumstances or conditions.
- The CHARGE lamp may remain lit longer than six hours, but this is not a malfunction.

**4 Insert the charged batteries.**

Bottom

While pressing OPEN, open the battery cover.

Match ⊕/⊖ and insert.

Close the cover.

2 Turn the camera on/set the clock

**1 Select**

**2 Press POWER.**

Lighting

**3 Set the clock with the control button.**

1 Select the date display format with ▲/▼, then press ●.

2 Select each item with ◀/▶ and set the numeric value with ▲/▼, then press ●.

3 Select [OK] with ▶, then press ●.

• To cancel, select [Cancel] and press ●.

3 Insert a "Memory Stick" (not supplied)

Terminal side

Open the "Memory Stick" cover.

Insert the "Memory Stick" all the way in until it clicks.

Close the cover.

When there is no "Memory Stick" inserted

The camera records/plays back images using the internal memory (32 MB). → "User's Guide/Troubleshooting" (page 24)

4 Select the image size for use

**1 Select a mode.**

Still image:

Movie:

**2 Press / (Image Size).**

**3 Select the size with ▲/▼.**

5M  
3:2  
3M  
1M  
VGA(E-Mail)  
Image Size

• The screen above is for still images. For movies, select [640(Fine)] ("Memory Stick PRO" only), [640(Standard)] or [160].

**4 Press / (Image Size) to complete the setting.**



2629893120

Checking the accessories supplied

- Ni-MH battery charger BC-CS2A/CS2B (1)
- USB cable (1)
- Lens cap (1)/Lens cap strap (1)
- Power cord (mains lead) (1)
- A/V cable (1)
- Shoulder strap (1)
- Lens hood (1)
- HR6 (size AA) Nickel-Metal Hydride batteries (2)
- Adaptor ring (1)
- Battery case (1)
- CD-ROM (Cyber-shot application software) (1)
- Operating instructions for digital still camera "Read This First" (this manual) (1)
- Operating instructions "User's Guide/Troubleshooting" (1)
- A "Memory Stick" is not supplied. The camera has its own internal memory (32 MB), however, purchase of a "Memory Stick" is recommended.

Notes before use

- Charge the supplied batteries before using the camera for the first time.
- The camera is a precision instrument. Be careful not to bump the lens or the LCD screen, and not to apply force to it. Attach the shoulder strap to prevent the camera from damage by being dropped, etc. → "User's Guide/Troubleshooting" (page 16)

Additional information on this product and answers to frequently asked questions can be found at our Customer Support Website.

Using batteries other than the supplied ones

You can use HR 15/51:HR6 (size AA) Nickel-Metal Hydride batteries/ZR6 (size AA) Oxy Nickel Primary Battery. → "User's Guide/Troubleshooting" (page 98)

Using the AC Adaptor

You can connect the camera using the AC-L5SK AC Adaptor (not supplied). → "User's Guide/Troubleshooting" (page 15). Refer to the operating instructions supplied with the AC Adaptor.

To check the remaining battery time

Press POWER to turn on and check the time on the screen.

Battery remaining indicator				
Battery remaining guidelines	Sufficient power remaining	Battery half full	Battery low, recording/playback will stop soon.	Change the batteries with fully charged ones, or charge the batteries. (The warning indicator flashes.)

- The displayed time remaining may not be correct under certain circumstances.
- When using Oxy Nickel Primary Battery, the battery remaining indicator does not display the correct information.
- When the AC Adaptor (not supplied) is used, the battery remaining indicator is not displayed.

To remove the batteries

Hold the camera with the battery cover facing upward, then open the battery cover and remove the batteries. Be careful not to drop the batteries.

To use your camera abroad — Power sources

You can use your camera, the supplied battery charger, and the AC Adaptor (not supplied) in any country or region where the power supply is within 100 V to 240 V AC, 50/60 Hz. Use a commercially available AC plug adaptor [a], if necessary, depending on the design of the wall outlet (wall socket) [b].

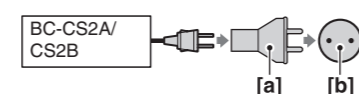

- Do not use an electronic transformer (travel converter), as this may cause a malfunction.

To change the date and time

Select [Clock Set] in the (Setup) screen and perform the procedure in step 3 above. → "User's Guide/Troubleshooting" (page 61)

On the clock display

- If you selected [D/M/Y] in step 1, set the time on a 24-hour cycle.
- Midnight is indicated as 12:00 AM, and noon as 12:00 PM.

When turning on the power

- Unless you set the clock, the Clock Set screen appears each time the camera is turned on.
- Do not touch the lens portion as the lens portion extends. Also, do not leave the camera with the lens portion extended for a long period of time with the power off as this may cause malfunction.
- The following screen appears when the camera is turned on for the second time or afterwards.



To turn off the power

Press POWER again.

- If the camera is running on battery power and you do not operate the camera for a period of time, the camera turns off automatically to prevent wearing down the battery (Auto power-off function).

Changing the language setting

You can change the screen display to show messages in a specified language. To change the language setting, press MENU to display the menu screen. Select (Setup) with the control button, then, select [A] Language in (Setup1), and select the desired language. → "User's Guide/Troubleshooting" (page 59)

On still image sizes

For details on the image size → "User's Guide/Troubleshooting" (page 13)

Image size	Guidelines	No. of images	Printing
5M (2592x1944) (the default setting)	For printing high density images in A4 or A5 size	Less	Fine
3:2 (2592x1728)*		More	Rough
3M (2048x1536)			
1M (1280x960)	For printing in postcard size		
VGA(E-Mail) (640x480)	For recording a larger number of images For attaching images to e-mail or creating web pages		

\*Images are recorded in the same 3:2 aspect ratio as photograph printing paper or postcards, etc.

On recordable number of still images and recordable time of movies

Recordable number of still images and recordable time of movies vary depending on the image size selected.

For details on recordable number or time → "User's Guide/Troubleshooting" (page 23)

Still images: Maximum recordable image

Movies: Maximum recordable time

- Number of recordable images and time can differ according to shooting conditions.

To remove a "Memory Stick"

Open the "Memory Stick" cover, then push the "Memory Stick" in once.

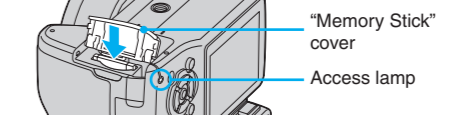

When the access lamp is lit

Never open the battery cover, remove the "Memory Stick" or turn off the power. The data may be corrupted.

# 5 Shoot images easily (Auto adjustment mode)

**Holding the camera**

Position the subject in the center of the focus frame.

**1 Select a mode.**  
**Still image (auto adjustment mode):**  
 Select .  
**Movie:**  
 Select .

**2 Shoot with the shutter button.**

**Still image:**

Press and hold halfway down to focus  
 AE/AF lock indicator Flashing → lit/beeps  
 Press fully down  
 The shutter sounds.

AF range finder frame

**Movie:**

Press fully down

To stop recording, press the shutter button fully down again.

# 6 Shoot still images (Scene Selection)

**1 Select the desired mode of Scene Selection** ( , , , , , , ).

• For details on modes, see below.

**2 Shoot with the shutter button.**

# 6 View/delete images

**1 Select** .

**2 Select an image with** .

Still image: the image size is displayed  
 Movie: is displayed  
 • You can easily view the next/previous image by turning the jog dial.

**Movie:**

To play back a movie, press .

Playback bar

Rewind/Fast forward:   
 (Return to normal playback: )  
 Volume:   
 Stop playback:

• Movies with the image size [160] are displayed a size smaller.

## Using the control button

Using the flash for still images

Checking the last image you shot (Quick Review)

Using the self-timer

Shooting close-up (Macro)

## Using the zoom

Zoom button

Pressing the button slightly zooms slowly and pressing the button fully down zooms fast.

- When the zoom scale exceeds 12x, the camera uses [Digital Zoom]. For details on the [Digital Zoom] settings and the image quality → "User's Guide/Troubleshooting" (page 51)
- You cannot change the zoom scale while shooting a movie.

## To cancel the Scene Selection

Set the mode dial to other than the mode of Scene Selection.

## To delete images

1 Display the image you want to delete and press (delete).  
 2 Select [Delete] with , then press .

**To cancel the deletion**  
 Select [Exit], then press .

## Checking the last still image you shot (Quick Review)

Press on the control button.  
 To cancel, press again.

- The image may appear rough right after playback starts.
- To delete the image, press (Delete) and select [Delete] with on the control button, then press .

## Selecting a flash mode for still images

Before step 2, press on the control button repeatedly until the desired mode is selected.

No indicator Strobes if it is dark or against light (default setting)

Forced flash

Slow synchro (Forced flash)  
 The shutter speed is slow in a dark place to clearly shoot the background that is out of flash light.

No flash

- The flash automatically pops up and strobes. Close the flash by hand after use.
- When the adaptor ring (supplied) or the lens hood (supplied) is attached, the flashlight is blocked.
- Shooting distance (when [ISO] is set to [Auto])  
 W side: Approx. 0.3 to 6.8 m (11 26/32 inches to 22 feet 3 23/32 inches)  
 T side: Approx. 0.9 to 5.2 m (2 feet 11 14/32 inches to 17 feet 23/32 inches)
- The flash strobes twice. The first time is to adjust the light quantity.

## Shooting close-up (Macro)

Before step 2, press on the control button.  
 To cancel, press again.

- Setting the zoom all the way to the W side is recommended.
- The in-focus range becomes narrow, and the complete subject may not entirely be in focus.
- The AF speed drops.

**Shortest shooting distance from the lens surface**  
 Setting all the way to the W side: Approx. 2 cm (13/16 inches)  
 Setting all the way to the T side: Approx. 90 cm (35 1/2 inches)

## Using the self-timer

Before step 2, press on the control button.  
 Press the shutter button, the self-timer lamp flashes, and a beep sounds until the shutter operates (approximately 10 seconds later).

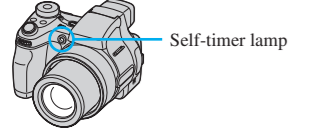

## If you shoot a still image of a subject that is difficult to focus on

- If the subject is closer than approx. 50 cm (19 3/4 inches) at W-side position, use the Macro mode (left column).
- When the camera cannot focus on the subject automatically, the AE/AF lock indicator changes to flashing slowly and the beep does not sound (except for Continuous AF, → "User's Guide/Troubleshooting" (page 51)). Recompose the shot and focus again.

### Subjects difficult to focus on are:

- Distant from the camera and dark
- The contrast between the subject and its background is poor.
- Seen through glass
- Moving fast
- Reflect light or have a lustrous finish
- Flashing
- Against light

## Anti-blur function

The anti-blur function is equipped with the camera.  
 To cancel the anti-blur function, set the mode dial to other than , then press the (STEADY SHOT) button to display the indicator. To turn on the anti-blur function, press the (STEADY SHOT) button again.

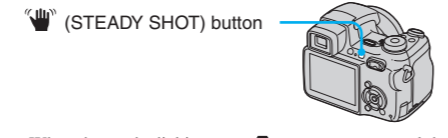

- When the mode dial is set to , you cannot cancel the anti-blur function.
- You can save the battery power when the anti-blur function is deactivated.
- You can change the anti-blur mode → "User's Guide/Troubleshooting" (page 54).

## To identify items on the screen

→ "User's Guide/Troubleshooting" (page 18)

## To shoot using the finder

With the FINDER/LCD button, you can choose to shoot either using the finder or the LCD screen. When you use the finder, the image does not appear on the LCD screen. Adjust the finder adjustment lever until the image appears clearly within the finder, then shoot the image.

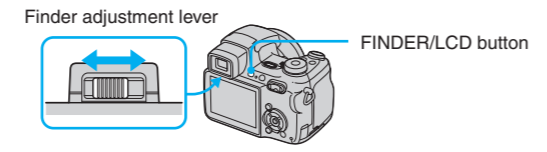

## Scene Selection modes

The following modes are predetermined to match the scene conditions.

<b>Twilight*</b> Shoots night scenes at a distance without losing the dark atmosphere of the surroundings.	<b>High-speed shutter</b> Shoots moving subjects in bright places.
<b>Twilight portrait*</b> Shoots portraits in dark places.	<b>Landscape</b> Shoots landscapes, etc., by focusing on a distant subject.
<b>Candle*</b> Shoot candlelit scenes, without spoiling the atmosphere.	<b>Portrait</b> Shoots with backgrounds blur away, and the subject is sharpened.
<b>Beach</b> Shoots seashores or lakesides, the blue of the water clearly recorded.	

\*The shutter speed becomes slower, so using a tripod is recommended.

## To use the functions set by the control button with Scene Selection

Before shooting in step 2, select the settings with the control button. Some functions are not available, depending on the Scene Selection mode. When you press the button to select functions that cannot be combined with Scene Selection, a beep sounds. → "User's Guide/Troubleshooting" (page 28)

## To view an enlarged image (playback zoom)

While displaying a still image, press to zoom in on the image.  
 To undo the zoom, press .  
 Adjust the portion:   
 Cancel playback zoom:   
 To store enlarged images: [Trimming] → "User's Guide/Troubleshooting" (page 49)

## Viewing an index screen

Press (index), then select an image with .  
 To return to the single-image screen, press . To display the next (previous) index screen, press .

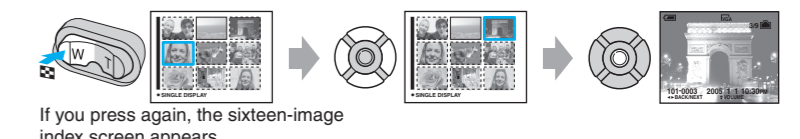

## To delete images in index mode

1 While an index screen is displayed, press (Delete) and select [Select] with on the control button, then press .

2 Select the image you want to delete with , then press to display the (Delete) indicator on the selected image.

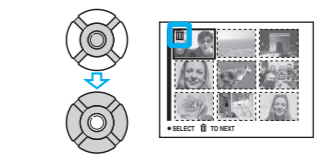

**To cancel a selection**  
 Select an image you have previously selected for deletion, then press to delete the from the image.

3 Press (Delete).  
 4 Select [OK] with , then press .

- To delete all the images in the folder, select [All In This Folder] with in step 1 instead of [Select], then press .