

YP-S2

# MP3 Player

## user manual

**imagine** the possibilities

Thank you for purchasing this Samsung product.  
To receive a more complete service, please  
register your product at

[www.samsung.com/global/register](http://www.samsung.com/global/register)



# features of your new MP3 Player

Good looking. Smart. Reliable. And lots of fun. Your new MP3 player is all this and more. Its compact silhouette takes up the tiniest space in your pocket. You'll love your new MP3 player, whether you're exercising or downloading your favorite tunes.

Use it once, and you'll wonder how you ever lived without it.

---

## **SIMPLE DESIGN IN A PEBBLE SHAPE**

Compact, simple and portable design.

---

## **EXPANSION AND COMPATIBILITY**

With your new player, you're not limited to MP3 files. Your player supports MP3, WMA and Ogg formats.

---

## **NECKLACE EARPHONE**

With the necklace-shaped earphones you can enjoy music without the inconvenience of tangled wires.

---

## **FREEDOM OF MY FAVORITE SELECTION WITH THIS MP3 PLAYER!**

You can create a playlist of your favorite music.

---

## **LONGER PLAY TIME AND SHORTER DOWNLOADING!**

A fully charged battery can play up to 13 hours of music.

Download times are shorter. Because of its USB 2.0 capability, the player is much faster than models with USB 1.1.









---

## **ACOUSTIC WONDER**

Your new MP3 player has built-in DNSe™ (Digital Natural Sound engine), Samsung's unique sound technology created to deliver richer, deeper sound for an unbelievable listening experience.

# safety information

## What the icons and signs in this user manual mean :

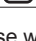
 WARNING	Means that death or serious personal injury is a risk.
 CAUTION	Means that there is a potential risk for personal injury or material damage.
 CAUTION	To reduce the risk of fire, explosion, electric shock, or personal injury when using your MP3 Player, follow these basic safety precautions:
 NOTE	Means hints or referential pages that may be helpful to operate the player.
	Do NOT attempt.
	Do NOT disassemble.
	Do NOT touch.
	Follow directions explicitly.
	Unplug the power plug from the wall socket.
	Call the service center for help.

These warning signs are here to prevent injury to you and others. Please follow them explicitly. After reading this section, keep it in a safe place for future reference.

# safety information

---

This manual describes how to properly use your new mp3 player. Read it carefully to avoid damaging the player and injuring yourself. Pay particular attention to the following serious warnings:

## PROTECT YOURSELF

---



- Do not disassemble, repair, or modify this product on your own.



CAUTION

- Do not get the product wet or drop it in water. If the product gets wet, do not switch it on because you could get an electric shock. Instead, contact Samsung's Customer Service Center near you.
- Do not use the product during a thunderstorm, as it may cause malfunction or a risk of electric shock.



CAUTION

- Do not use the earphones while you are driving a bicycle, automobile or motorcycle.  
It can cause a serious accident, and furthermore, is prohibited by law in some areas. Using the earphones while walking or jogging on a road, in particular, on a crosswalk can lead to a serious accident.
- For your safety, make sure the earphone cable does not get in the way of your arm or other surrounding objects while you are taking exercise or a walk.



WARNING

- Do not place the product in damp, dusty, or sooty areas because these environments could lead to fire or electric shock.

## PROTECT YOURSELF

---



- Using earphones or headphones for an extended time may cause serious damage to your hearing.

If you are exposed to sound louder than 85db for an extended time, you may adversely affect your hearing. The louder the sound is, the more seriously damaged your hearing may be (an ordinary conversation is between 50 to 60db and road noise is approximately 80db).

You are strongly advised to set the volume level to medium (the medium level is usually less than 2/3 of the maximum).

- If you feel a ringing in the ear(s), lower the volume or stop using the earphones or headphones.

## PROTECT YOUR MP3 PLAYER

---



- Do not leave the player in temperatures above 95°F (35°C), such as a sauna or a parked car.
- Do not cause excessive impact on the player by dropping it.
- Do not place heavy objects on top of the player.
- Prevent any foreign particles or dust from entering into the product.
- Do not place the product near magnetic objects.



- Be sure to backup important data. Samsung is not responsible for data loss.
- Use only accessories provided by or approved by Samsung.



CAUTION

- Do not spray water on the product. Never clean the product with chemical substances such as benzene or thinner, as it may cause fire, electric shock or deteriorate the surface.



CAUTION

- Failure to follow these instructions may lead to physical injuries or damage to the player.



NOTE

- When printing this user manual, we recommend that you print in color and check "Fit to Page" in the print option for better viewing.

# contents

---

## THE BASICS

8

- 8 What's included
- 9 Your MP3 Player
- 11 Charging the battery
- 12 Caring for the battery
- 12 Turning the power on & off
- 13 Playing music
- 13 Controlling the volume
- 13 Resetting the system

## SAMSUNG MEDIA STUDIO

14

- 14 PC requirements
- 15 Installing Samsung Media Studio
- 16 Transferring files to the player with Samsung Media Studio
- 19 Using as a removable disk
- 20 Disconnecting from your PC

## LISTENING TO MUSIC

21

- 21 Playing music
- 21 Pausing
- 22 Searching within a track
- 22 Playing from the beginning of the current track
- 22 Playing the previous track
- 22 Playing the next track

# contents

---

- 23 Smart button custom function**
- 23 To set the Digital Natural Sound Engine (DNSe)
- 23 To set the Play Mode
- 23 To turn off the LED
- 24 Creating a playlist on your mp3 player**
- 24 To play a playlist**
- 24 To delete a music file from the playlist**

- TROUBLESHOOTING 25 Troubleshooting**

25

- APPENDIX 28 Product specifications**

28

# the basics

---

## WHAT'S INCLUDED

---

Your new mp3 player comes with these accessories. If you're missing any of these items, contact Samsung Customer Service Center near you.

---



**Player**

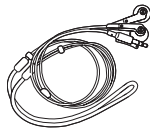

**Earphones**

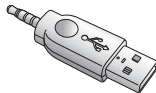

**Direct Connect USB Adaptor**

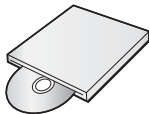

**Installation CD**

The accessories in your box may look slightly different than these.



## YOUR MP3 PLAYER

---

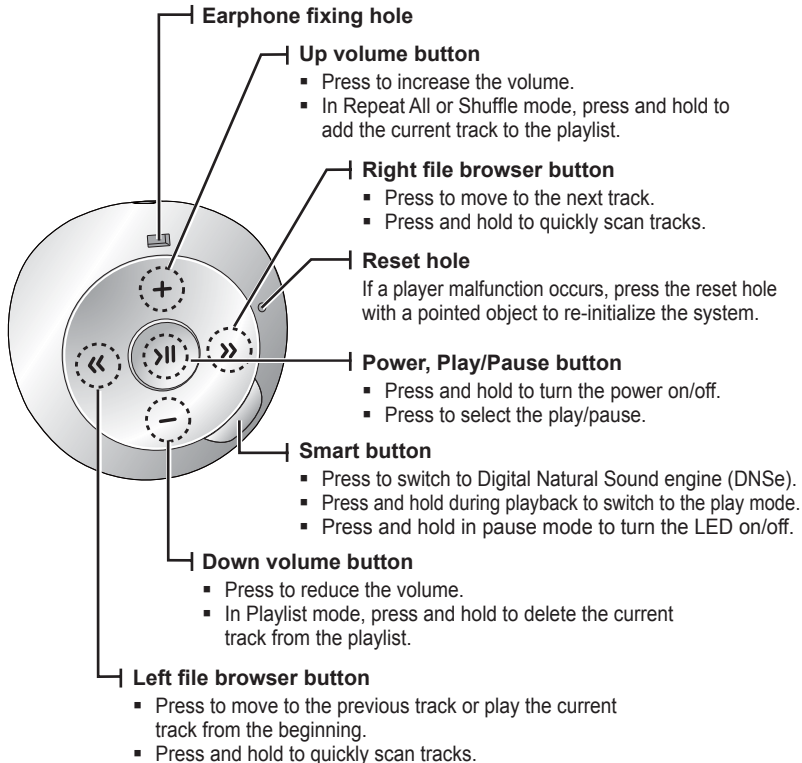

## YOUR MP3 PLAYER (Continued)

---

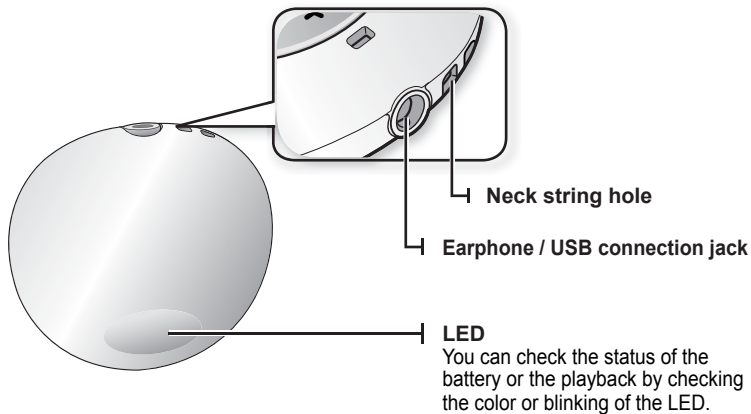

Connect the earphones



Connect the direct connect USB adaptor

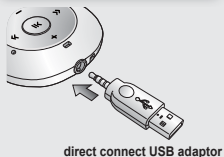

## CHARGING THE BATTERY

---

Charge the player before using it for the first time and when you haven't used it for a long time.

The battery for your mp3 player will fully charge in about 2 hours, although total charging time varies depending on your PC environment.



- **Before you start** - Remove the earphones before connecting the direct connect USB adaptor.

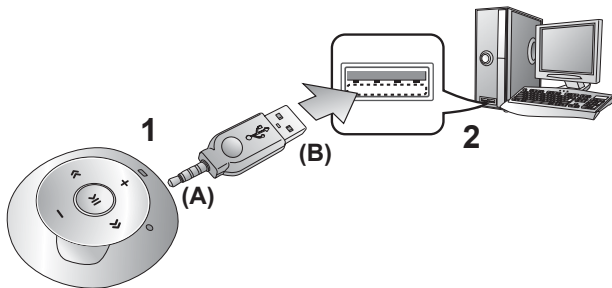

1. Connect the mini plug end (A) of the direct connect USB adaptor to the Earphone/USB Connection Jack of the player.
2. Connect the wide (USB) end (B) of the direct connect USB adaptor to the USB port (  ) on your PC as in the figure above.
  - The LED will blink red while the battery is being charged. When done, it turns green.



NOTE

- When you need to recharge the battery.
  - When the battery is too low, the LED blinks red and the color of the selected play mode alternates. If the LED is turned off, this will not work.
  - When the battery runs out, the LED blinks red.
- If you are charging the player while it is connected to a laptop computer, make sure the laptop's battery is also fully charged or that the laptop is plugged into its power source.

## CARING FOR THE BATTERY

---

Your battery will last longer if you follow these simple guidelines for caring and storing it.

- Recharge and store the battery within the temperature range of 40°F~95°F (5°C~35°C ).
- Do not overcharge (longer than 12 hours).  
Excessive charging or discharging may shorten the battery's life.
- Battery life naturally shortens slowly over time.

## TURNING THE POWER ON & OFF

---

### Turning the Power on

Press and hold the [ >|| ] button.

- The LED will flash blue and Power is turned on.

### Turning the Power off

Press and hold the [ >|| ] button.

- The player turns off with a beep.

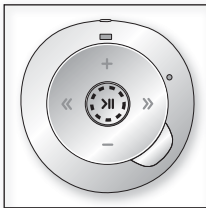

NOTE

- The player will be automatically turned off when none of the buttons have been pressed for 1 minute in the pause mode.

## PLAYING MUSIC

---

Press and hold the [ >|| ] button.

- The LED will flash blue and the music file will begin playing.

## CONTROLLING THE VOLUME

---

Press the [ + , - ] button.

- The volume range is set between 0 to 30.
- Press the [ + ] button to increase the volume or the [ - ] button to decrease it.



NOTE

- If you selected over 15, the volume will be set back to 15 when you turn the player off to avoid hearing damage when you turn the player back on.



## RESETTING THE SYSTEM

---

If your mp3 player won't turn on, won't play music, or isn't recognized by your computer when you connect it, you may have to reset the system.

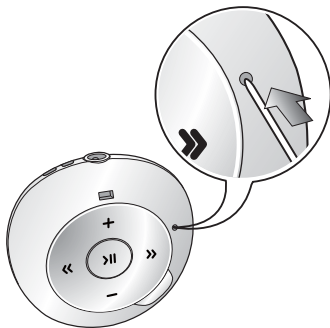

Press the Reset hole at the rear of the player with a pointed object such as a safety clip.

- The system will be initialized.
- Your settings and files will not be affected.

# Samsung Media Studio

Samsung Media Studio is an easy-to-use software application that helps you organize your files on your PC. With your files already sorted and organized in Media Studio, you can quickly transfer them to your mp3 without searching your entire hard drive for the right file.

## **PC REQUIREMENTS**

---

Your PC system must meet the following minimum specifications in order to install and run Media Studio:

- Pentium 500MHz or higher
- USB Port 2.0
- Windows 2000/XP/Vista
- DirectX 9.0 or higher
- 100MB of free hard disc space
- CD Rom Drive (2X or higher)
- Windows Media Player 9.0 or higher
- Resolution 1024 X 768 or higher
- Internet Explorer 6.0 or higher
- 512 MB RAM or higher

# INSTALLING SAMSUNG MEDIA STUDIO

---



- Ensure that you run the <Media Studio> installer in your PC's administrator account. Otherwise, <Media Studio> will not be installed. To find the administrator account, please refer to your PC's user manual.
- Use care when inserting the Installation CD into a vertically oriented CD-ROM drive.

1. Insert the Installation CD provided with the player into the CD-ROM drive of your computer.



2. Click **<Install now>**.

- Follow the instruction to start installation.
- <Media Studio> installation starts and then creates an icon  on your desktop when installation is complete.

## TRANSFERRING FILES TO THE PLAYER WITH SAMSUNG MEDIA STUDIO

<Media Studio> enables you to select and organize files and folders before transferring them to your player. This will make scanning files on your mp3 player easier and faster. <Media Studio> file transfer is the easiest way to get files from your PC to your mp3 player.

- ★ **Before you start** - Remove the earphones before connecting the direct connect USB adaptor.

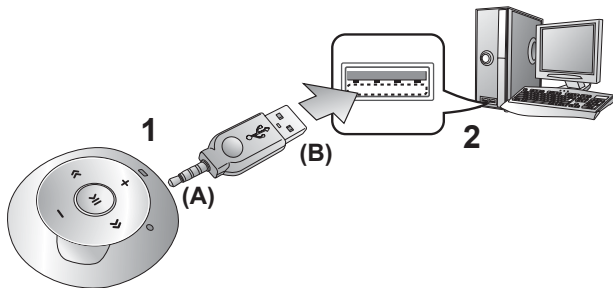

1. Connect the mini plug end (A) of the direct connect USB adaptor to the Earphone/USB Connection Jack of the player.
2. Connect the wide (USB) end (B) of the direct connect USB adaptor to the USB port (↔) on your PC as in the figure above.
  - <Media Studio> will automatically start when the player is connected to your PC.
  - If the program does not start automatically, double click the <Media Studio> icon (📁) on the desktop.



NOTE

- Music recognition technology and related data are provided by Gracenote and Gracenote CDDB® Music Recognition Service<sup>SM</sup>.
- CDDB is a registered trademark of Gracenote. The Gracenote logo and logotype, the Gracenote CDDB logo and logotype, and the "Powered by Gracenote CDDB" logo are trademarks of Gracenote. Music Recognition Service and MRS are service marks of Gracenote.



# TRANSFERRING FILES TO THE PLAYER WITH SAMSUNG MEDIA STUDIO (Continued)

3. Click the icon for the type of file you want to transfer.

- Click  to display music list.

4. Click **<Add File>** on the bottom of **<Media Studio>**.

- The **<Open>** window will appear.

5. Select the files to add and click **<Open>**.

- The files are added to the list on the left side of the **<Media Studio>** Screen.

6. Select the file to transfer from the list on the left side.

7. Click the  icon.

- The file you selected is transferred to the player.
- The LED will blink blue during the file transfer.

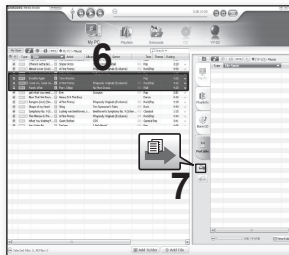
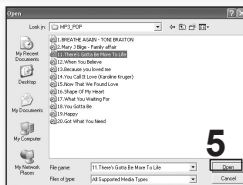

## TRANSFERRING FILES TO THE PLAYER WITH SAMSUNG MEDIA STUDIO (Continued)

---



CAUTION

- Do not disconnect the direct connect USB adaptor during file transfer with the LED blinking blue.  
Disconnecting during transfer may damage the player or your PC.
- When connecting via a USB port on the front of your PC or a USB hub, it may not connect properly. If there is an unstable connection, connect it via the USB port on the rear of your PC.



NOTE

- All functions are disabled during connection.
- If you connect the direct connect USB adaptor to the PC and the player's Battery charge is low, the player will be charged for several minutes before connecting to the PC.
- Use FAT 32 for the file system when formatting the player on your PC.  
In Windows Vista, click Restore device defaults and format it.
- Samsung Media Studio has a thorough Help function. If you can't find the answer to your question about Media Studio, click <MENU> → <Help> → <Help> on the top of the <Media Studio> program.

## USING AS A REMOVABLE DISK

You can use the player as a removable storage device.

★ ▪ **Before you start** - Connect the player to your PC.

1. Open files/folders to transfer from your PC.
2. Open **<My Computer>** → **<S2>** from the desktop.
3. Select the files/folders to transfer from your PC and drag-and-drop them to a folder of your choice in the **<S2>**.
  - The selected folders or files are transferred to the player.
  - The LED will blink blue during the file transfer.

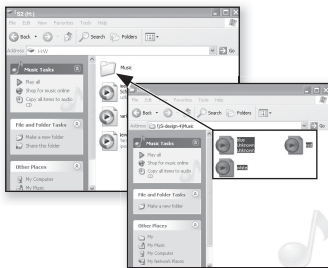

CAUTION

- Do not disconnect the direct connect USB adaptor during file transfer with the LED blinking blue.  
Disconnecting during transfer may damage the player or your PC.
- The order of music files displayed in your PC may differ from the play order on your player.
- If you transfer a DRM file(charged file) to the removable disk, the file will not be played.
- **What is DRM?**  
Digital Rights Management (DRM) is a technology and service to prevent the illegal use of digital contents and protect the profit and rights of copyright holders. DRM files are charged music files applied with the illegal copy protection technology of legally purchased MP3 music.

## DISCONNECTING FROM YOUR PC

---

Follow the steps below to prevent damage to the player and data when disconnecting from your PC.

1. Place the mouse cursor on top of the  icon on the taskbar at the bottom right corner of the desktop and click the left mouse button.



2. Click the **<Safely Remove USB Mass Storage Device Drive>** message.

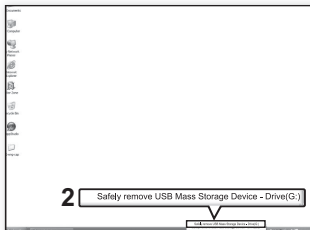

3. Disconnect the player from your PC.



- Do not disconnect the player from the PC during file transfer with the LED blinking blue. This may cause damage to data and the player.
- You cannot remove the player while files within the player are being played on your PC. Please retry after file playback is finished.

# Listening to music

---

- ★ ▪ **Before you start** - Connect the earphones, then turn on the player, and check the battery.

## PLAYING MUSIC

---

Press and hold the [ >|| ] button.

- The LED will flash blue and the music file will begin playing.
- During playback, the LED will blink in the color of the selected play mode once every 3 seconds.  
Go to page 23 to see what color indicates which different play mode.



- MP3, WMA and Ogg music files are compatible with the player.
- MP1 or MP2 files which only have a changed extension to MP3 may not play on the player.
- If you try to play when no files are present, the LED does not turn on and you will hear a beep each time you press the button.
- If you try to play a file that is not playable, the LED blinks in the color of the selected play mode once every 1.5 seconds with a beep.
- The music files will be played in sequence following the characters, numbers and upper / lower case alphabetical letters in the file name.



## PAUSING

---

1. Press the [ >|| ] button while the music is playing.
  - The music playback will be paused.
  - In pause mode, the LED will blink in the color of the selected play mode once every 1.5 seconds.
2. Press the [ >|| ] button again.
  - The music will play from the point where it stopped.

## SEARCHING WITHIN A TRACK

---

1. Press and hold the [ **⏮** , **⏭** ] **button** while the selected track is playing.
  - It searches to the beginning or the end of the track.
2. Release the button at the point you wish to start.
  - It starts playing from the point you release the button.

## PLAYING FROM THE BEGINNING OF THE CURRENT TRACK

---

Press the [ **⏮** ] **button** after 4 seconds of play has elapsed from the beginning of the track.

- The current track starts playing from the beginning.

## PLAYING THE PREVIOUS TRACK

---

Press the [ **⏮** ] **button** before 4 seconds of play has elapsed from the beginning of the track.

Press the [ **⏮** ] **button** twice after 4 seconds of play has elapsed from the beginning of the track.

- The previous track will start playing.

## PLAYING THE NEXT TRACK

---

Press the [ **⏭** ] **button**.

- The next track will start playing.



- When playing VBR (Variable Bit Rate) files, the previous track may not play even if you press the [ **⏮** ] **button** within 4 seconds.

# SMART BUTTON CUSTOM FUNCTION

---

You can use the Smart button to set DNSe, the play mode, and turn off the LED.

## To set the Digital Natural Sound engine (DNSe)

---

You can select a desired sound effect.

During music playback, press the **Smart button**.

- Each time you press the button, the sound effect will switch to Normal, Studio and Concert Hall in sequence.

### Sound Effect Options

---

- Normal: You can enjoy a sharp and clear sound.
- Studio: This offers natural sound and is appropriate to most music genres.
- Concert Hall: This option simulates the sound of a concert hall.

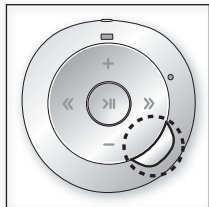

## To set the Play Mode

---

You can select a play mode of a music file such as Repeat All, Shuffle and Playlist.

During music playback, press and hold the **Smart button** and the following options will be available in sequence.

### Play Mode Options

---

- Blue LED (Repeat All mode): The player repeats playing all music files with a long beep.
- Green – Blue – Magenta alternately LED (Shuffle mode): The player plays music files at random with a beep.
- Magenta LED (Playlist mode): The player plays the playlist with a beep.

## To turn off the LED

---

You can turn off the LED during music playback.

Press and hold the **Smart button** in pause mode.

- The LED will turn off.
- To turn it back on, press and hold the Smart button in pause mode.



NOTE

- The Playlist mode(Magenta LED) will not be selected until you add at least one music file to the playlist.



NOTE

### ▪ **What is DNSe?**

Digital Natural Sound Engine (DNSe) is a sound effect function for MP3 players developed by Samsung. It provides various sound settings to enhance the type of music you're listening to.

## CREATING A PLAYLIST ON YOUR MP3 PLAYER

---

If you've already downloaded files to your mp3 player, you can create a "Favorites" playlist without Media Studio or your PC.

1. During music playback, press and hold the **Smart button** until the LED flashes blue (Repeat All mode) or green – blue – magenta alternately (Shuffle mode).
  2. Select a music file to add to the playlist, and press and hold the **[ + ] button**.
    - The selected music file will be added to the playlist with a beep.(long tone)
-  NOTE
- You can add up to 30 music files to the playlist.
  - If the playlist is full, the player deletes files starting from the first added file and adds a new file at the end with a beep.
  - An already added file can not be added again.

## TO PLAY A PLAYLIST

---

During music playback, press and hold the **Smart button** until the LED flashes magenta (Playlist mode).

- The player switches to the playlist mode with a beep.
- The music files in the playlist will be played at random.

## TO DELETE A MUSIC FILE FROM THE PLAYLIST

---

1. During music playback, press and hold the **Smart button** until the LED flashes magenta (Playlist mode).
2. Select a music file to delete from the playlist, and press and hold the **[ - ] button**.
  - The selected music file will be deleted from the playlist with a beep.



NOTE

- The Playlist mode (Magenta LED) will not be selected until you add at least one music file to the playlist.



# troubleshooting

---

If you have a problem with your new mp3 player, check for a solution in this list. If the problem persists, contact a Samsung Customer Service Center near you.

<b>PROBLEM</b>	<b>SOLUTION</b>
<b>Power will not turn on.</b>	<ul style="list-style-type: none"><li>• Power will not turn on if the battery is completely drained. Recharge the battery and turn the power on again.</li><li>• Press the Reset hole.</li></ul>
<b>Buttons do not work.</b>	<ul style="list-style-type: none"><li>• Check if you pressed the right button, then press again.</li><li>• Press the Reset hole.</li></ul>
<b>Power is turning off.</b>	<ul style="list-style-type: none"><li>• The power is automatically turned off when the battery is completely drained. Recharge the battery.</li><li>• Your mp3 player will be automatically turned off when none of the buttons have been pressed for 1 minute in the pause mode. Turn on the Player.</li></ul>
<b>Battery life differs from what is stated in the manual.</b>	<ul style="list-style-type: none"><li>• The battery life can vary depending on the sound mode.</li><li>• Battery life may be shortened when the player is left for extended periods in low or high temperatures.</li></ul>

<b>PROBLEM</b>	<b>SOLUTION</b>
<b>Media Studio Program malfunction.</b>	<ul style="list-style-type: none"> <li>• Check if your PC meets the basic system requirements.</li> </ul>
<b>Connection to your PC is disabled.</b>	<ul style="list-style-type: none"> <li>• Check if the direct connect USB adaptor is correctly connected and try again.</li> <li>• Press <b>&lt;Start&gt;</b> on the toolbar of your PC to run Windows Update. Select Key Updates and Service Packs, then update all. Reboot your PC and reconnect.</li> <li>• When connecting via a USB port on the front of your PC or a USB hub, it may not connect properly. If there is an unstable connection, connect it via the USB port on the rear of your PC.</li> </ul>
<b>The file transfer rate is too slow.</b>	<ul style="list-style-type: none"> <li>• If you have formatted the player on Windows 2000, the file transfer may be delayed. Format the player on Windows XP or Vista and try again.</li> <li>• If you are running multiple programs including &lt;Media Studio&gt; on your PC, the file transfer rate will be slow. Exit unnecessary programs and try transferring again.</li> </ul>
<b>Player isn't playing.</b>	<ul style="list-style-type: none"> <li>• Check if the available file has been saved in the memory of the player.</li> <li>• Check if the music file is damaged.</li> <li>• Check if there is enough battery power.</li> <li>• This player does not support secure WMA files from online stores.</li> </ul>
<b>File upload doesn't work.</b>	<ul style="list-style-type: none"> <li>• Check if the direct connect USB adaptor is securely connected. Reconnect if necessary.</li> <li>• Check if the memory is full.</li> <li>• Press the Reset hole.</li> </ul>

<b>PROBLEM</b>	<b>SOLUTION</b>
<b>Files or data are missing.</b>	<ul style="list-style-type: none"><li>• Check if the direct connect USB adaptor has been disconnected during file or data transmission. If this is the case, it may cause serious damage not only to files/data but also to the product. You have to be extra cautious as Samsung is not responsible for data loss.</li></ul>
<b>The product is hot.</b>	<ul style="list-style-type: none"><li>• Heat may be generated during recharging. This has no effect on the product life or functions.</li></ul>

# appendix

---

## PRODUCT SPECIFICATIONS

---

<b>Model Name</b>	YP-S2
<b>Rating</b>	DC 5.0V / 500mA
<b>Built-in Battery Power</b>	200 mAh / DC 3.7V
<b>File Compatibility</b>	<b>AUDIO</b> : MPEG1/2/2.5 Layer3(8kbps~320kbps, 8kHz~48kHz), WMA(48kbps~192kbps,8kHz~48kHz), Ogg(Q0~Q10)
<b>Supported Number of folders and files</b>	Folder: Max. 2000 / File: Max. 2000
<b>Earphone Output</b>	16mW/Ch. (France 5mW/Ch.) (based on 16Ω)
<b>Output Frequency Range</b>	40Hz~20KHz
<b>Signal to Noise Ratio</b>	88 dB with 20 KHz LPF(based on 1kHz 0 dB)
<b>Play Time</b>	Maximum of 13 hours for music playback (based on : MP3 128kbps, Volume 15, Normal sound mode).
<b>Temperature Range for Operation</b>	-5~35°C (23~95°F)
<b>Case</b>	Plastic
<b>Weight</b>	17.2 g
<b>Dimensions (WxHxD)</b>	41.2 X 42.4 X 16.7 mm

The contents of this Manual are subject to change without prior notice for further improvement.

## LICENSE

---

The product player accompanying this user manual is licensed under certain intellectual property rights of certain third parties. This license is limited to private non-commercial use by end-user consumers for licensed contents. No rights are granted for commercial use.

The license does not cover any product player other than this product player and the license does not extend to any unlicensed product player or process conforming to ISO/IEC 11172-3 or ISO/IEC 13818-3 used or sold in combination with this product player. The license only covers the use of this product player to encode and/or decode audio files conforming to the ISO/IEC 11172-3 or ISO/IEC 13818-3. No rights are granted under this license for product features or functions that do not conform to the ISO/IEC 11172-3 or ISO/IEC 13818-3.

## EUROPE ONLY

---

This marking shown on the product or its literature, indicates that it should not be disposed with other household wastes at the end of its working life. To prevent possible harm to the environment or human health from uncontrolled waste disposal, please separate this from other types of wastes and recycle it responsibly to promote the sustainable reuse of material resources.

Household users should contact either the retailer where they purchased this product, or their local government office, for details of where and how they can take this item for environmentally safe recycling.

Business users should contact their supplier and check the terms and conditions of the purchase contract. This product should not be mixed with other commercial wastes for disposal.



## CONTACT SAMSUNG WORLD WIDE

If you have any questions or comments relating to Samsung products, please contact the SAMSUNG customer care center.

Country	Customer Care Center ☎	Web Site
CANADA	1-800-SAMSUNG(726-7864)	<a href="http://www.samsung.com/ca">www.samsung.com/ca</a>
MEXICO	01-800-SAMSUNG(726-7864)	<a href="http://www.samsung.com">www.samsung.com</a>
U.S.A	1-800-SAMSUNG(726-7864)	<a href="http://www.samsung.com">www.samsung.com</a>
ARGENTINE	0800-333-3733	<a href="http://www.samsung.com/ar">www.samsung.com/ar</a>
BRAZIL	0800-124-421 , 4004-0000	<a href="http://www.samsung.com">www.samsung.com</a>
CHILE	800-SAMSUNG(726-7864)	<a href="http://www.samsung.com/cl">www.samsung.com/cl</a>
NICARAGUA	00-1800-5077267	
HONDURAS	800-7919267	
COSTA RICA	0-800-507-7267	<a href="http://www.samsung.com/latin">www.samsung.com/latin</a>
ECUADOR	1-800-10-7267	<a href="http://www.samsung.com/latin">www.samsung.com/latin</a>
EL SALVADOR	800-6225	<a href="http://www.samsung.com/latin">www.samsung.com/latin</a>
GUATEMALA	1-800-299-0013	<a href="http://www.samsung.com/latin">www.samsung.com/latin</a>
JAMAICA	1-800-234-7267	<a href="http://www.samsung.com/latin">www.samsung.com/latin</a>
PANAMA	800-7267	<a href="http://www.samsung.com/latin">www.samsung.com/latin</a>
PUERTO RICO	1-800-682-3180	<a href="http://www.samsung.com/latin">www.samsung.com/latin</a>
REP. DOMINICA	1-800-751-2676	<a href="http://www.samsung.com/latin">www.samsung.com/latin</a>
TRINIDAD & TOBAGO	1-800-SAMSUNG(726-7864)	<a href="http://www.samsung.com/latin">www.samsung.com/latin</a>
VENEZUELA	0-800-100-5303	<a href="http://www.samsung.com/latin">www.samsung.com/latin</a>
COLOMBIA	01-8000112112	<a href="http://www.samsung.com.co">www.samsung.com.co</a>
BELGIUM	0032 (0)2 201 24 18	<a href="http://www.samsung.com/be">www.samsung.com/be</a>
CZECH REPUBLIC	844 000 844	<a href="http://www.samsung.com/cz">www.samsung.com/cz</a>
DENMARK	70 70 19 70	<a href="http://www.samsung.com/dk">www.samsung.com/dk</a>
FINLAND	030-6227 515	<a href="http://www.samsung.com/fi">www.samsung.com/fi</a>
FRANCE	3260 SAMSUNG (€ 0,15/Min), 08 25 08 65 65 (€ 0,15/Min)	<a href="http://www.samsung.com">www.samsung.com</a>
GERMANY	01805 - SAMSUNG(726-7864) (€ 0,14/Min)	<a href="http://www.samsung.com">www.samsung.com</a>
HUNGARY	06-80-SAMSUNG(726-7864)	<a href="http://www.samsung.com">www.samsung.com</a>
ITALIA	800-SAMSUNG(726-7864)	<a href="http://www.samsung.com">www.samsung.com</a>
LUXEMBURG	0035 (0)2 261 03 710	<a href="http://www.samsung.com/be">www.samsung.com/be</a>
NETHERLANDS	0900-SAMSUNG(726-7864) (€ 0,10/Min)	<a href="http://www.samsung.com/nl">www.samsung.com/nl</a>

Country	Customer Care Center ☎	Web Site
NORWAY	815-56 480	www.samsung.com/no
POLAND	0 801 801 881 , 022-607-93-33	www.samsung.com/pl
PORTUGAL	80820-SAMSUNG(726-7864)	www.samsung.com/pt
SLOVAKIA	0800-SAMSUNG(726-7864)	www.samsung.com/sk
SPAIN	902 10 11 30	www.samsung.com
SWEDEN	0771-400 200	www.samsung.com/se
U.K	0845 SAMSUNG (7267864)	www.samsung.com
EIRE	0818 717 100	www.samsung.com/ie
AUSTRIA	0800-SAMSUNG(726-7864)	www.samsung.com/at
SWITZERLAND	0800-SAMSUNG(726-7864)	www.samsung.com/ch
RUSSIA	8-800-555-55-55	www.samsung.com
KAZAHSTAN	8-10-800-500-55-500	www.samsung.kz
UZBEKISTAN	8-10-800-500-55-500	www.samsung.uz
KYRGYZSTAN	00-800-500-55-500	
TADJIKISTAN	8-10-800-500-55-500	
UKRAINE	8-800-502-0000	www.samsung.com
LITHUANIA	8-800-77777	www.samsung.lt
LATVIA	800-7267	www.samsung.com/lv
ESTONIA	800-7267	www.samsung.ee
AUSTRALIA	1300 362 603	www.samsung.com
NEW ZEALAND	0800SAMSUNG(726-7864)	www.samsung.com/nz
CHINA	800-810-5858 , 010-6475 1880	www.samsung.com
HONG KONG	3698-4698	www.samsung.com/hk
INDIA	3030 8282 , 1800 110011	www.samsung.com
INDONESIA	0800-112-8888	www.samsung.com
JAPAN	0120-327-527	www.samsung.com/jp
MALAYSIA	1800-88-9999	www.samsung.com/my
PHILIPPINES	1800-10-SAMSUNG(726-7864)	www.samsung.com/ph
SINGAPORE	1800-SAMSUNG(726-7864)	www.samsung.com
THAILAND	1800-29-3232 , 02-689-3232	www.samsung.com
TAIWAN	0800-329-999	www.samsung.com/tw
VIETNAM	1 800 588 889	www.samsung.com
TURKEY	444 77 11	www.samsung.com
SOUTH AFRICA	0860-SAMSUNG(726-7864 )	www.samsung.com
U.A.E	800-SAMSUNG (726-7864), 8000-4726	www.samsung.com

